

1.

M2350_03

rauch

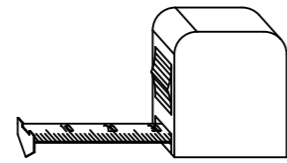
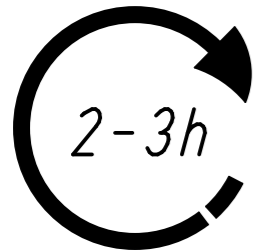
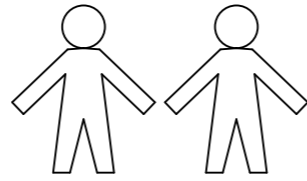
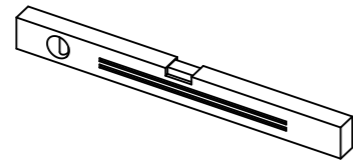
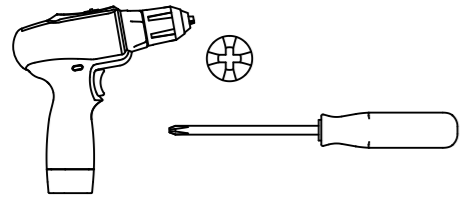

ABD-FOLIE
147x46

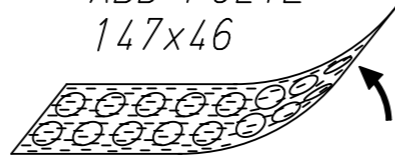

Typ I

Typ II

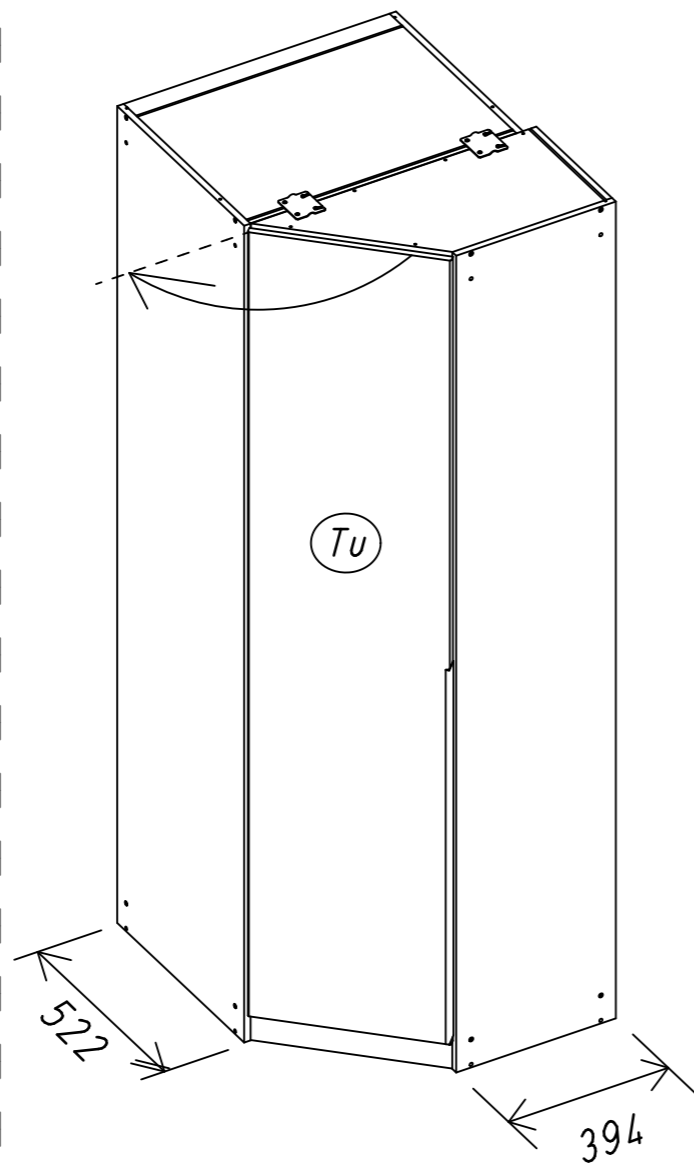
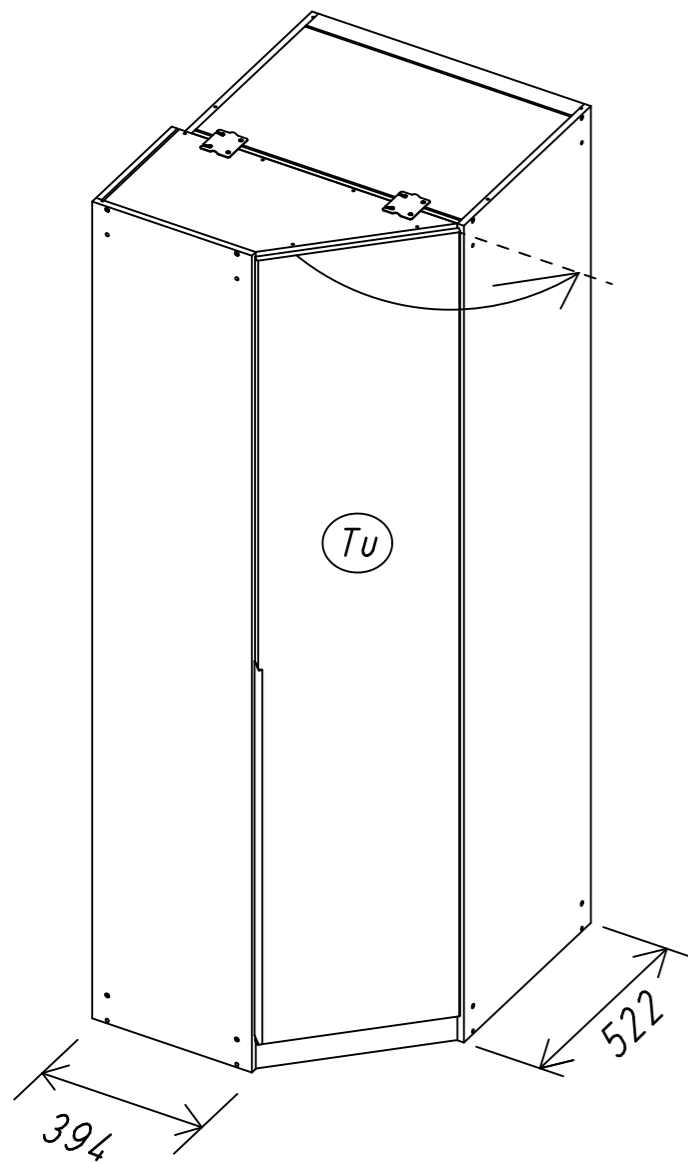

2.

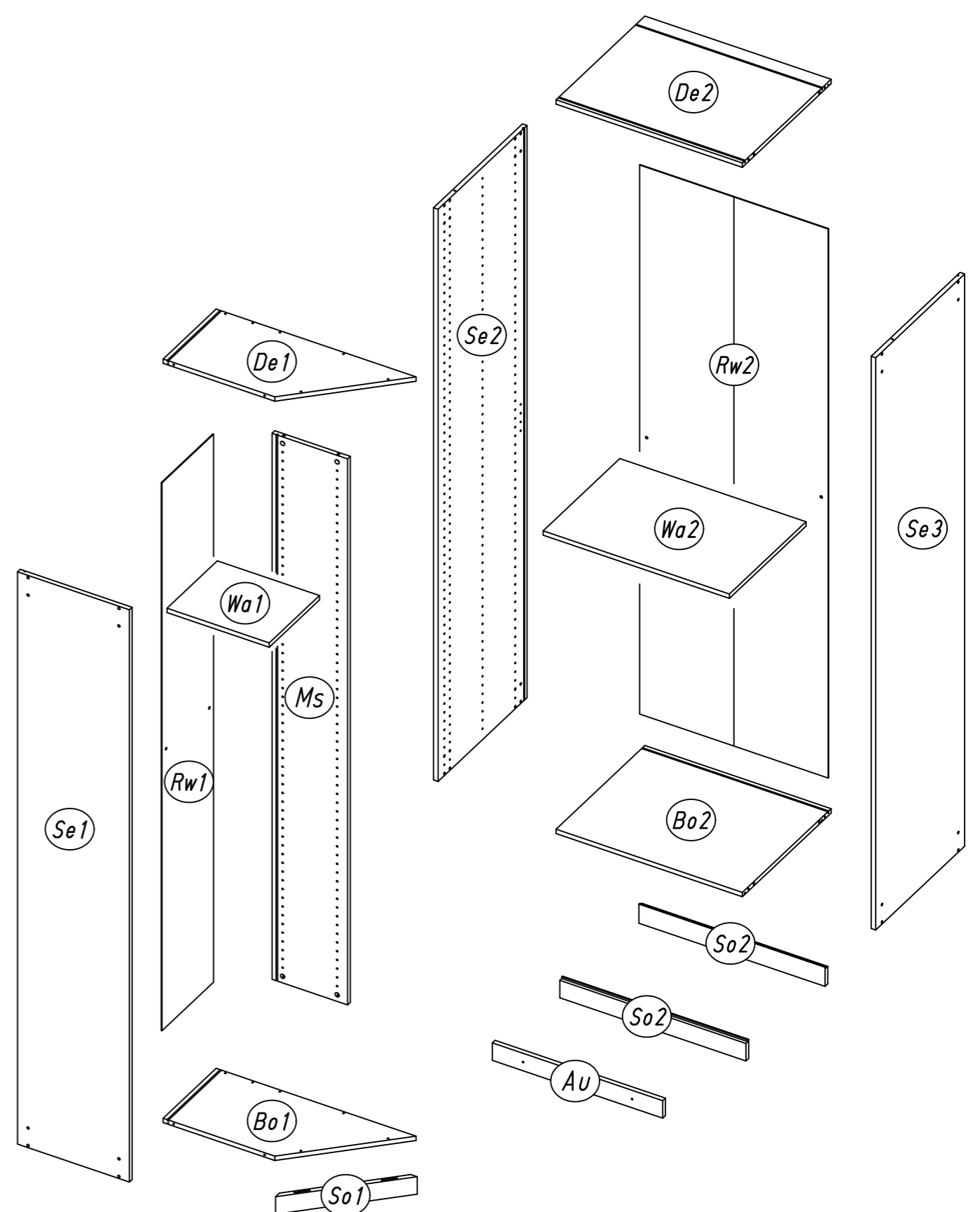

3.

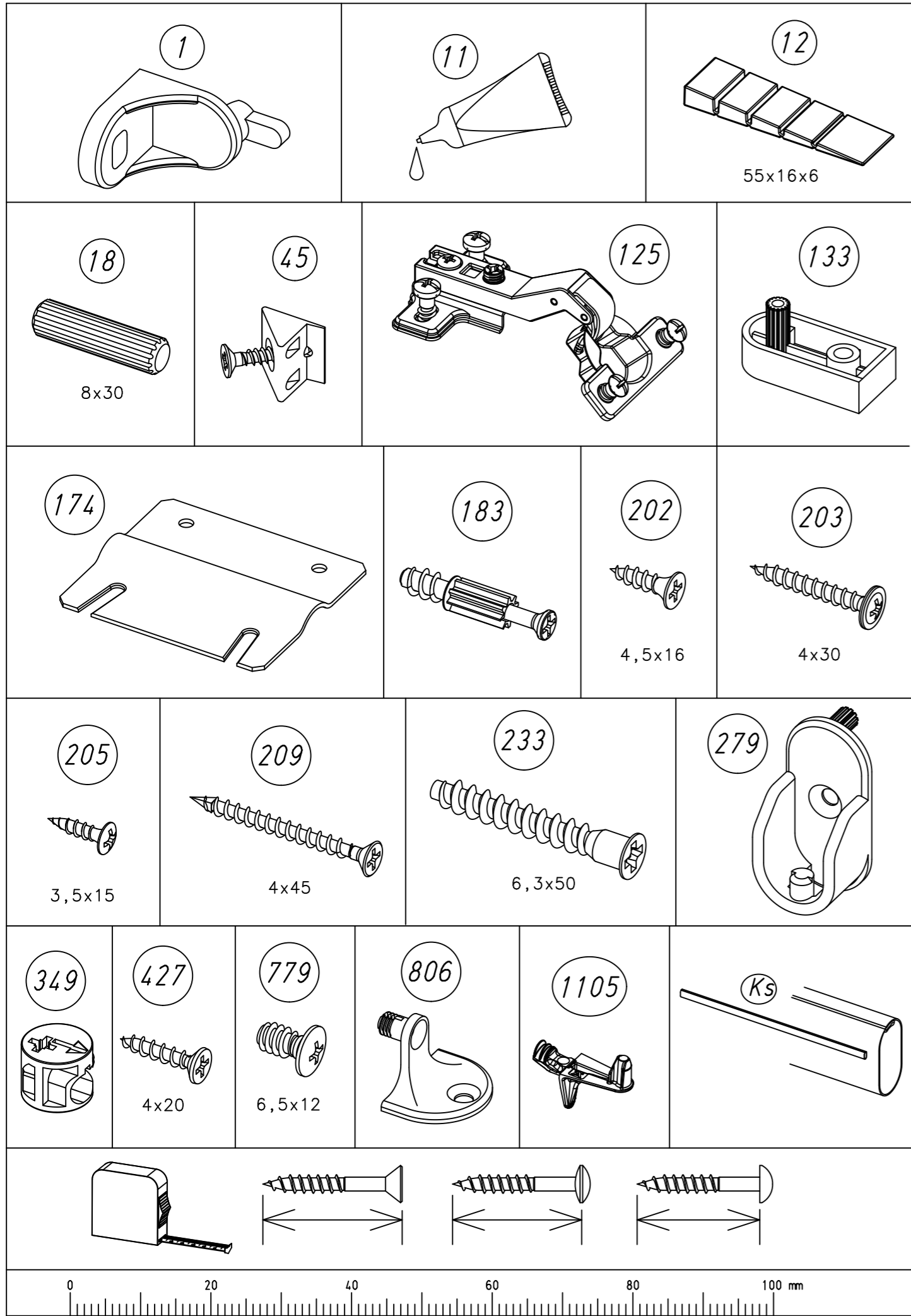

4.

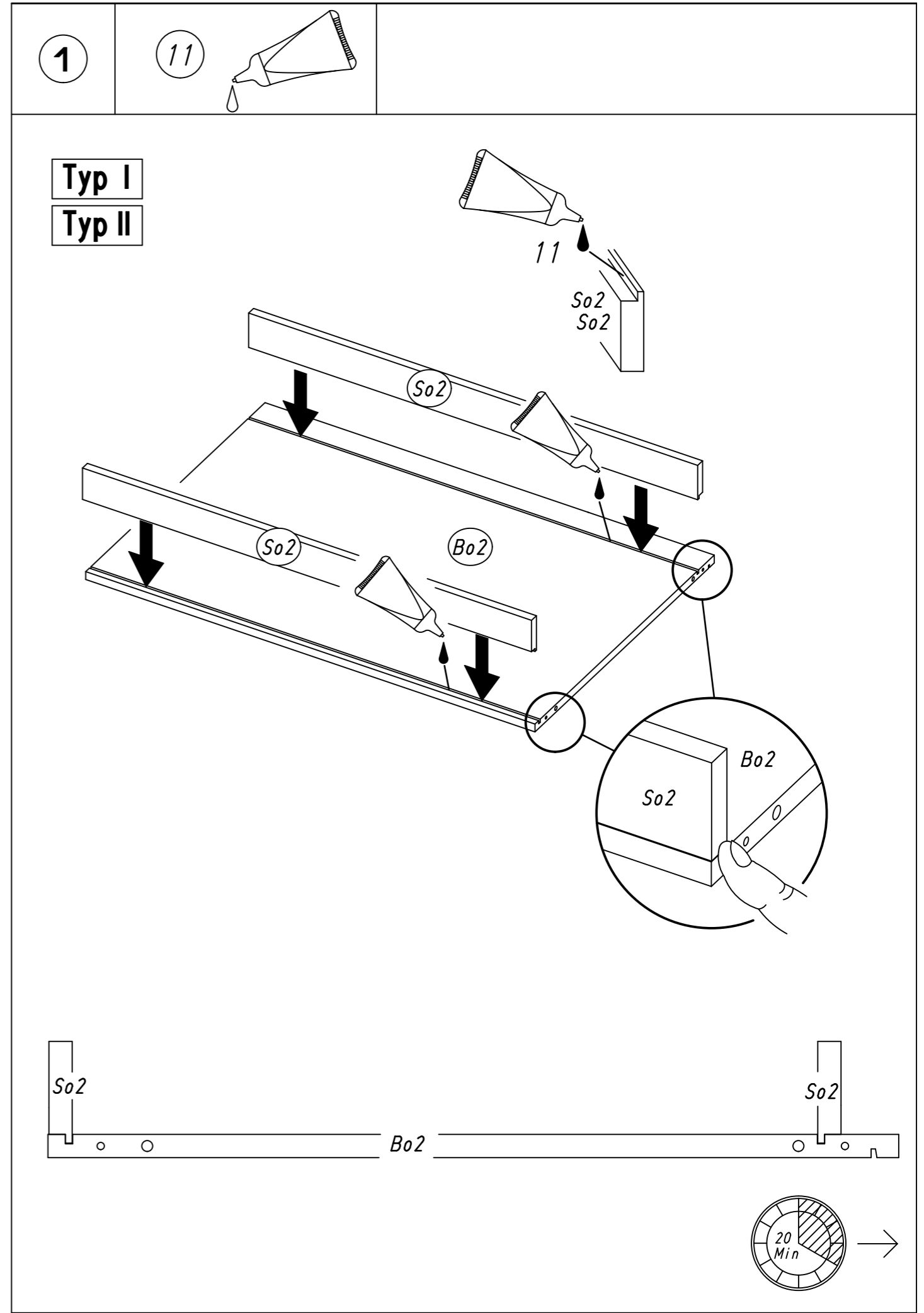

5.

2

4x 18

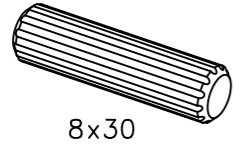

8x30

Typ I

Typ II

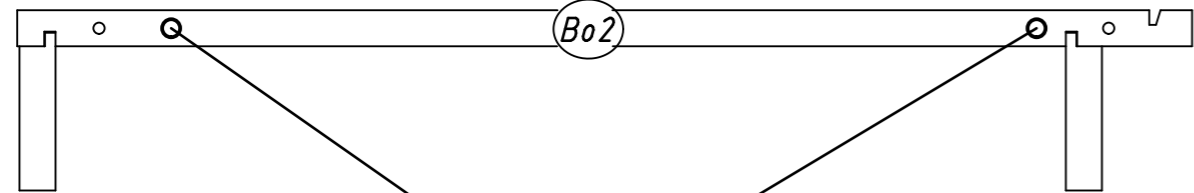

18

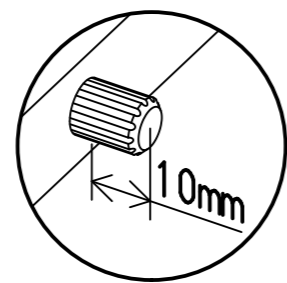

10mm

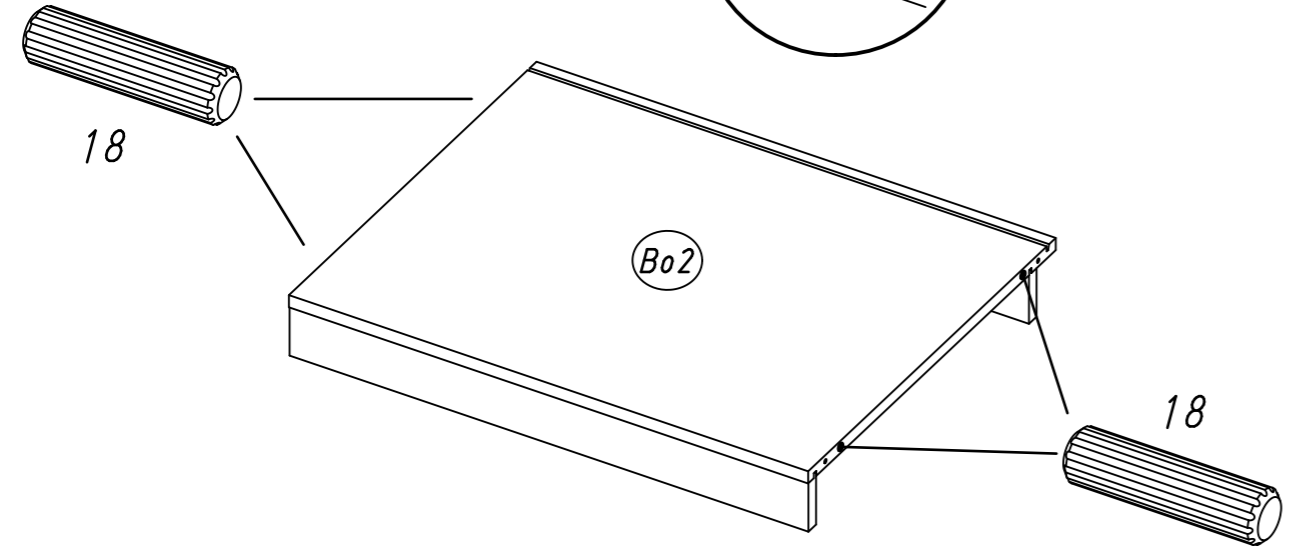

18

Bo2

18

6.

3

2x 233

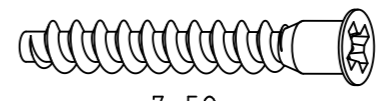

7x50

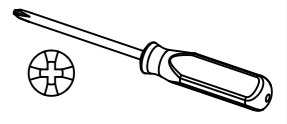

Typ I

Typ II

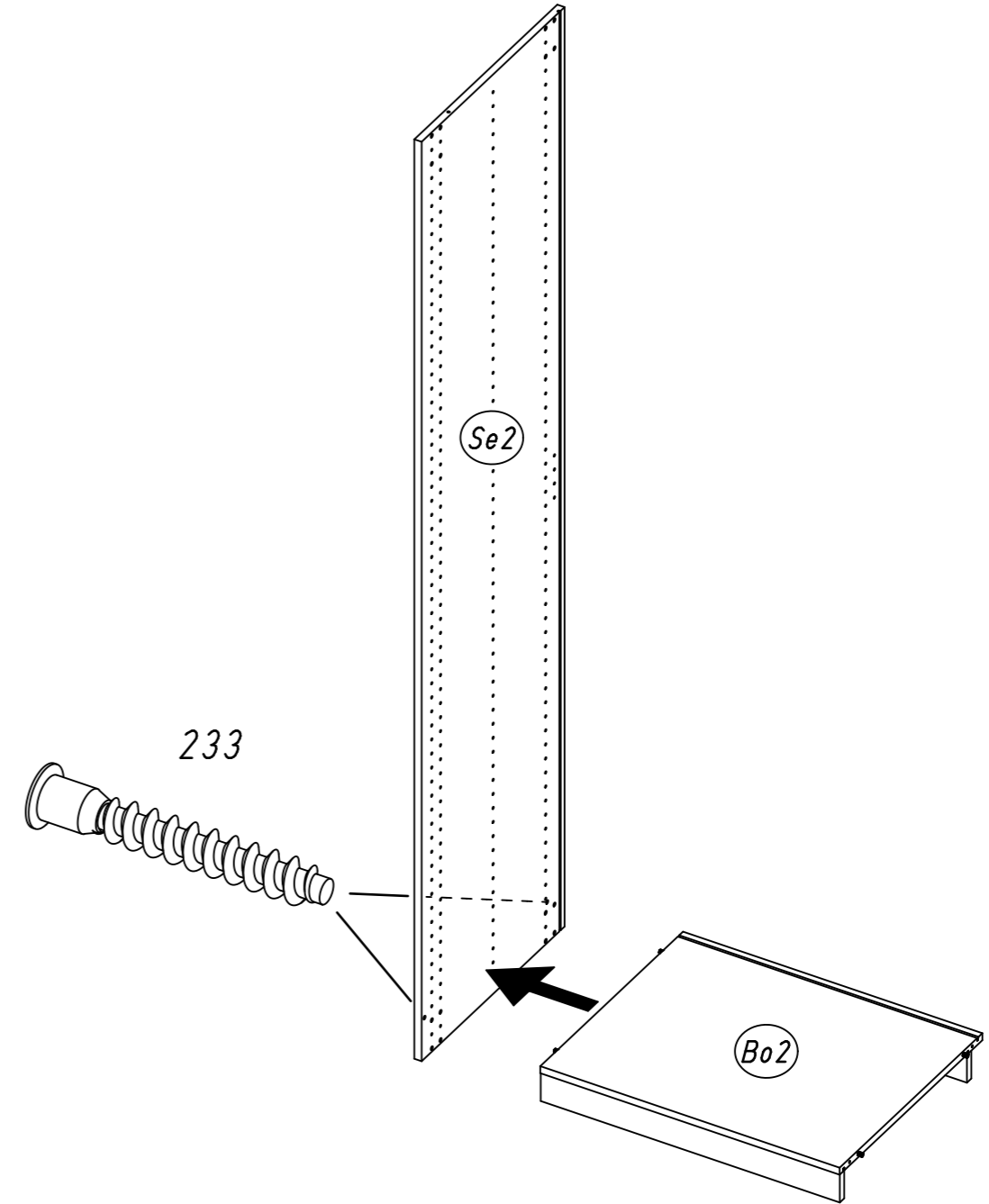

233

Se2

Bo2

7.

4

1x 1

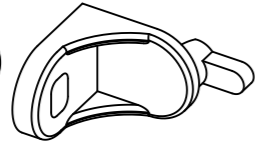

1x 779



6,5x12

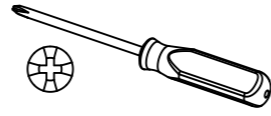

Typ I

Typ II

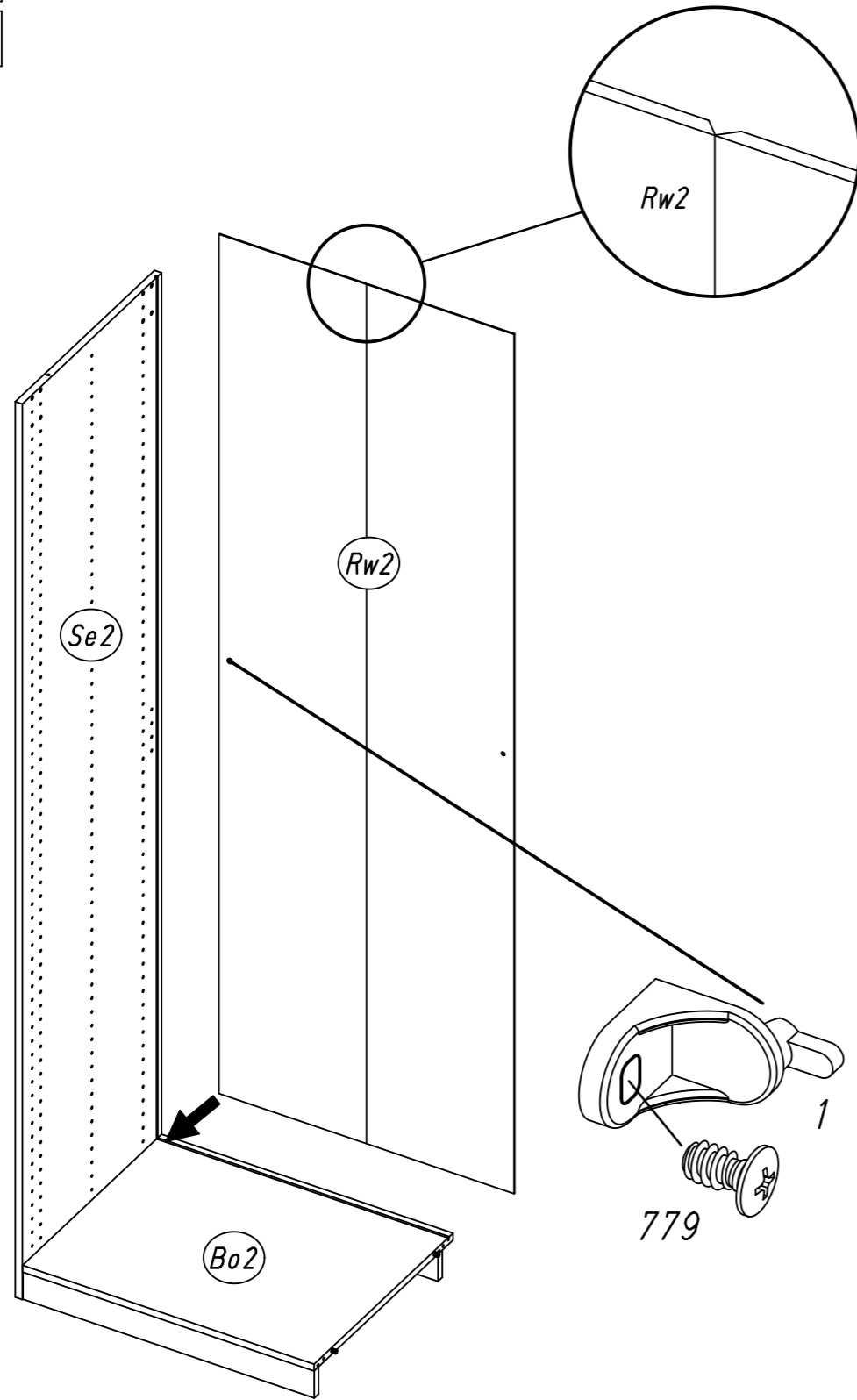

M2350

8.

5

4x 18

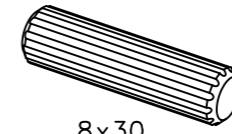

8x30

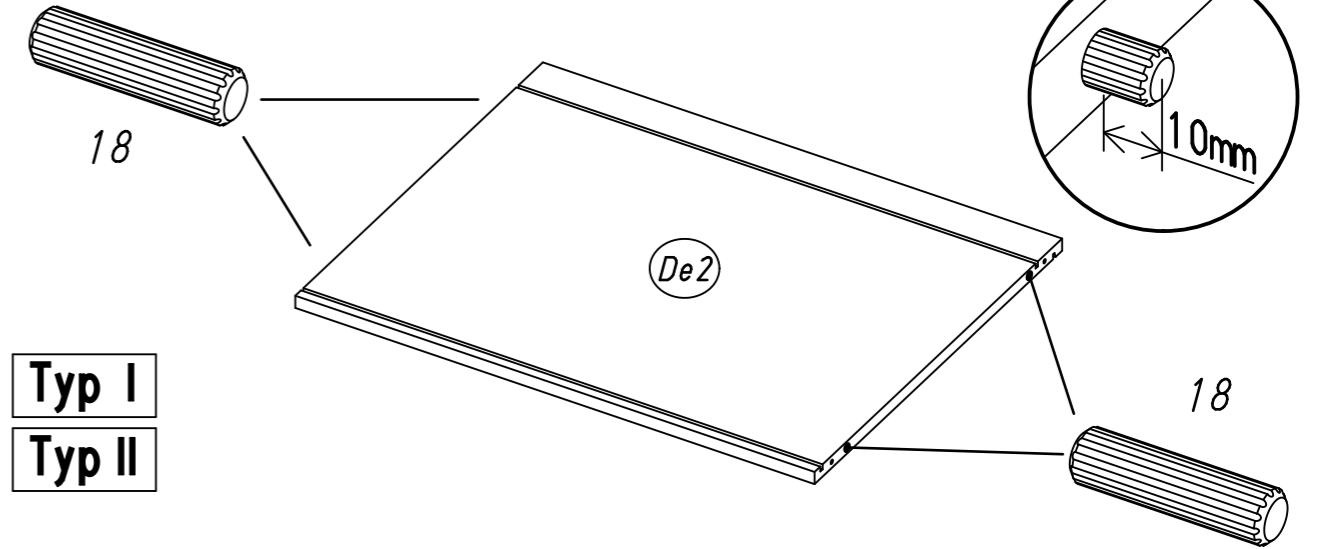

Typ I

Typ II

6

2x 233

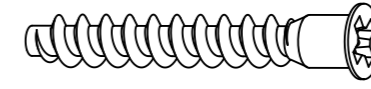

7x50

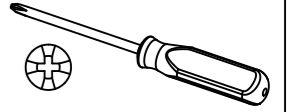

Typ I

Typ II

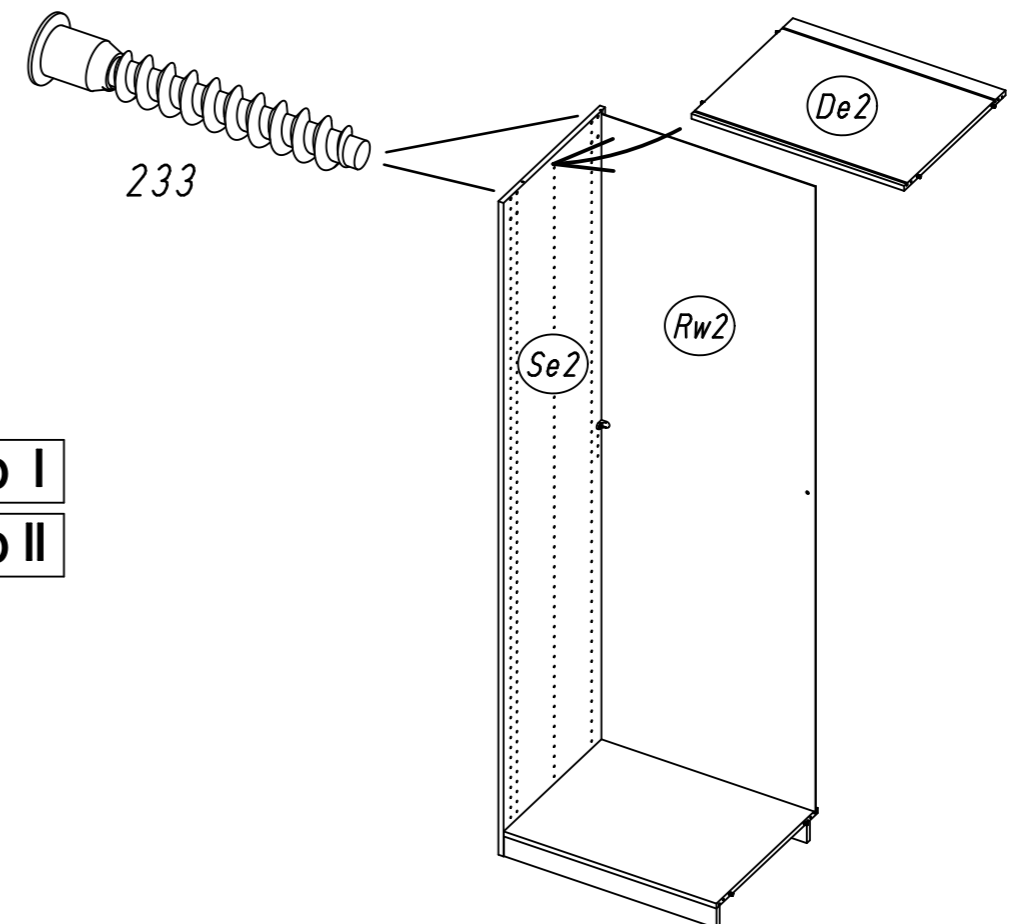

M2350

9.

7

4x 233

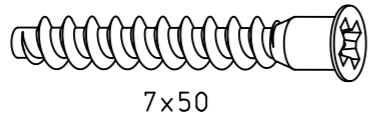

7x50

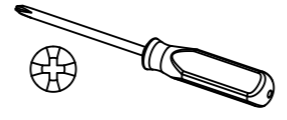

Typ I

Typ II

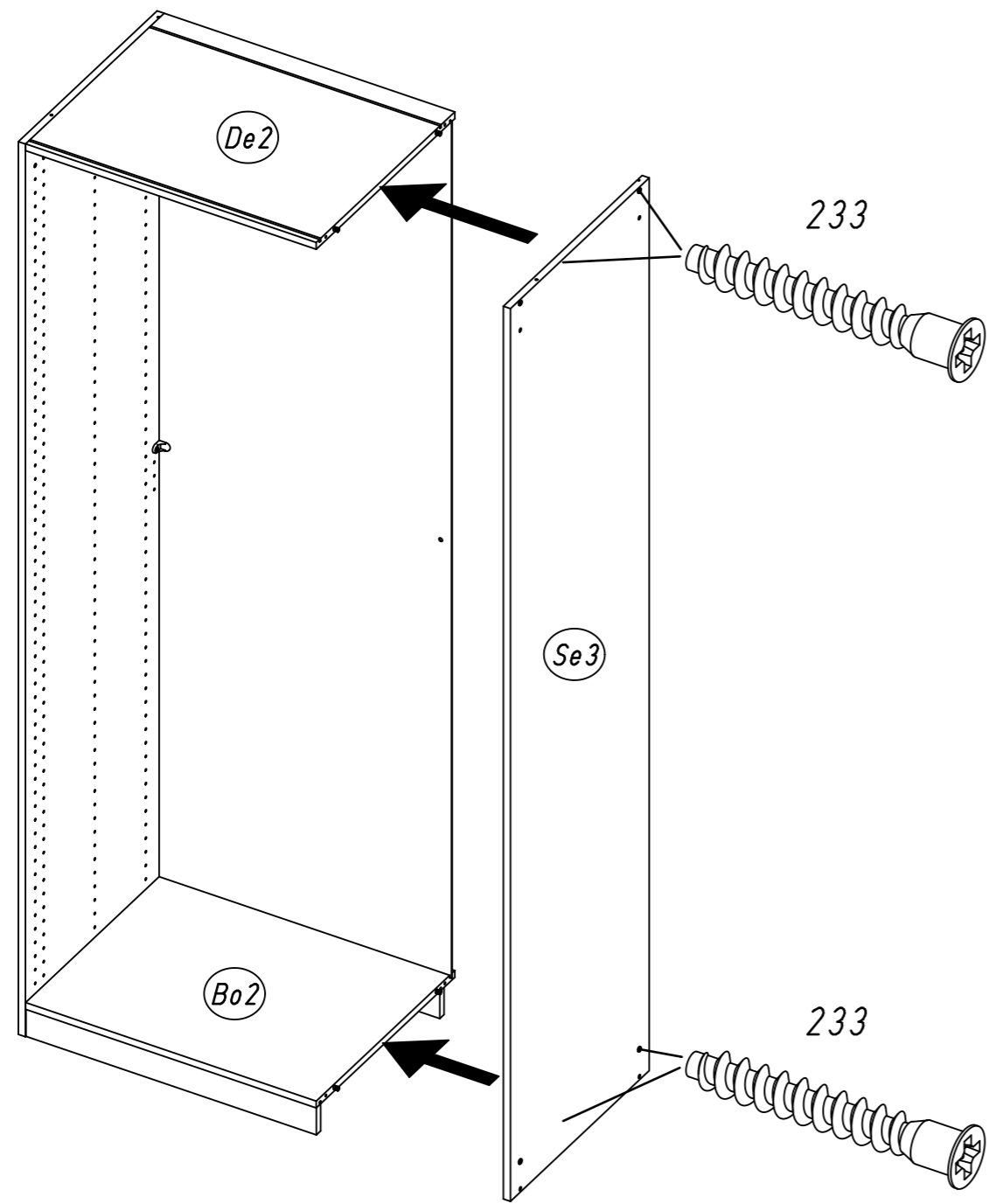

10.

8

1x 1

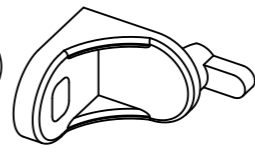

1x 779



6,5x12

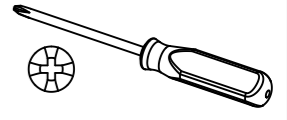

Typ I

Typ II

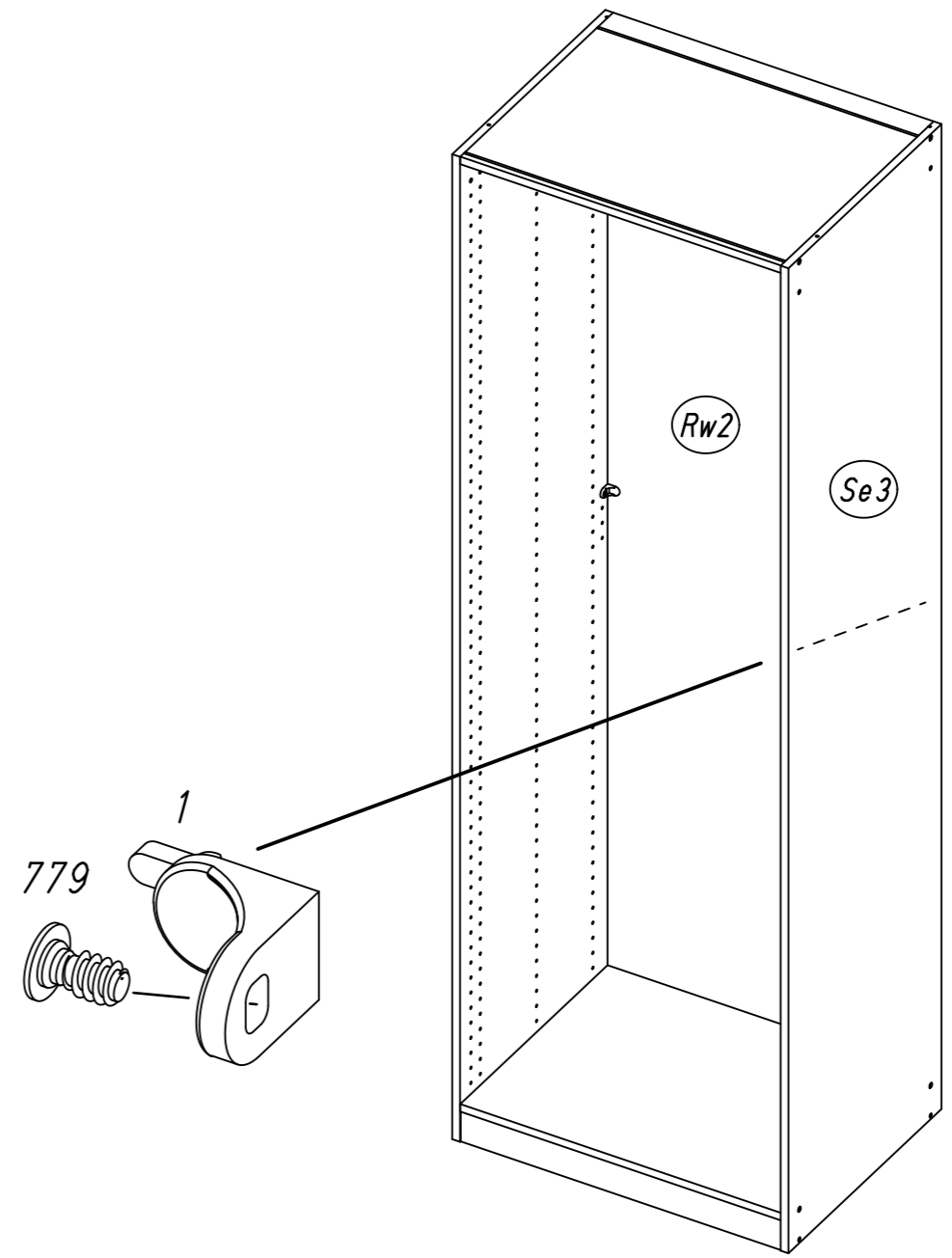

11.

9

2x 203

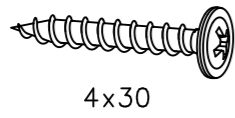

4x30

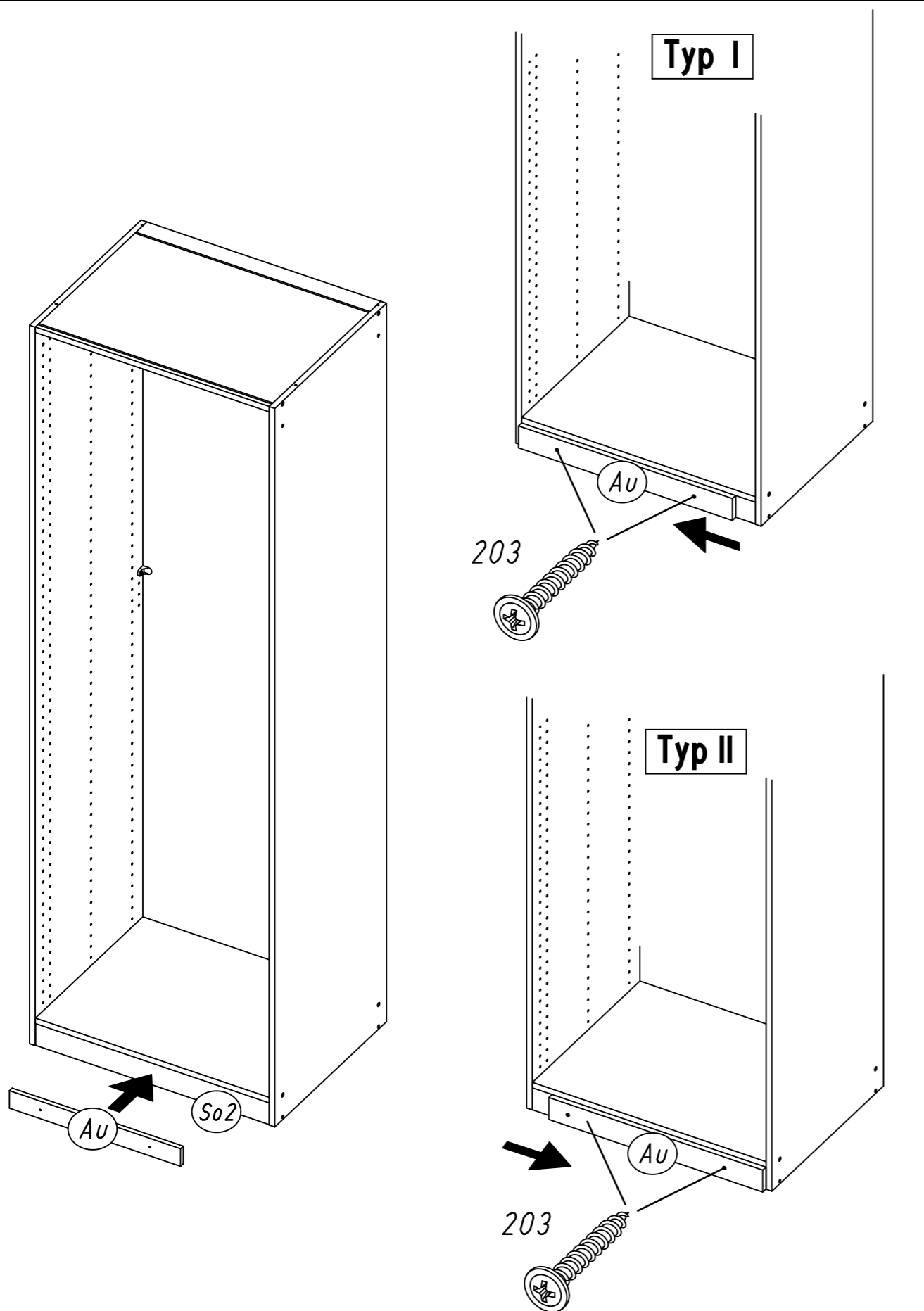
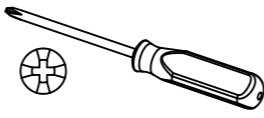

M2350

12.

10

2x 279



2x 205

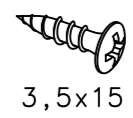

3,5x15

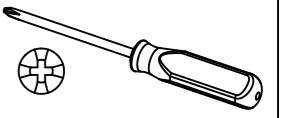

Typ I

Typ II

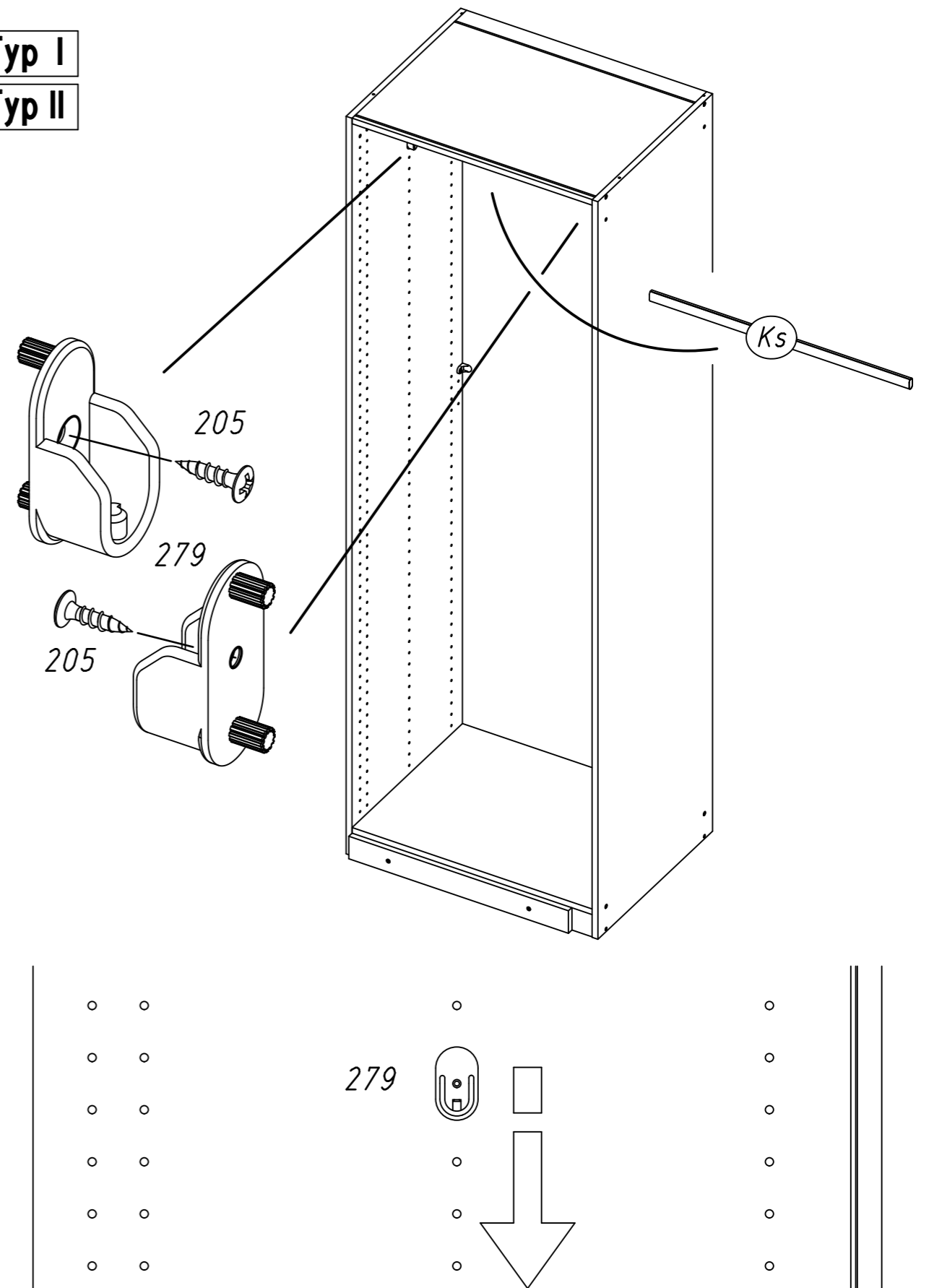

M2350

11

4x 1105

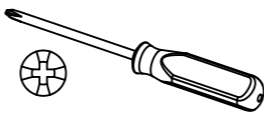
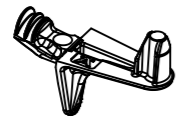

Typ I

Typ II

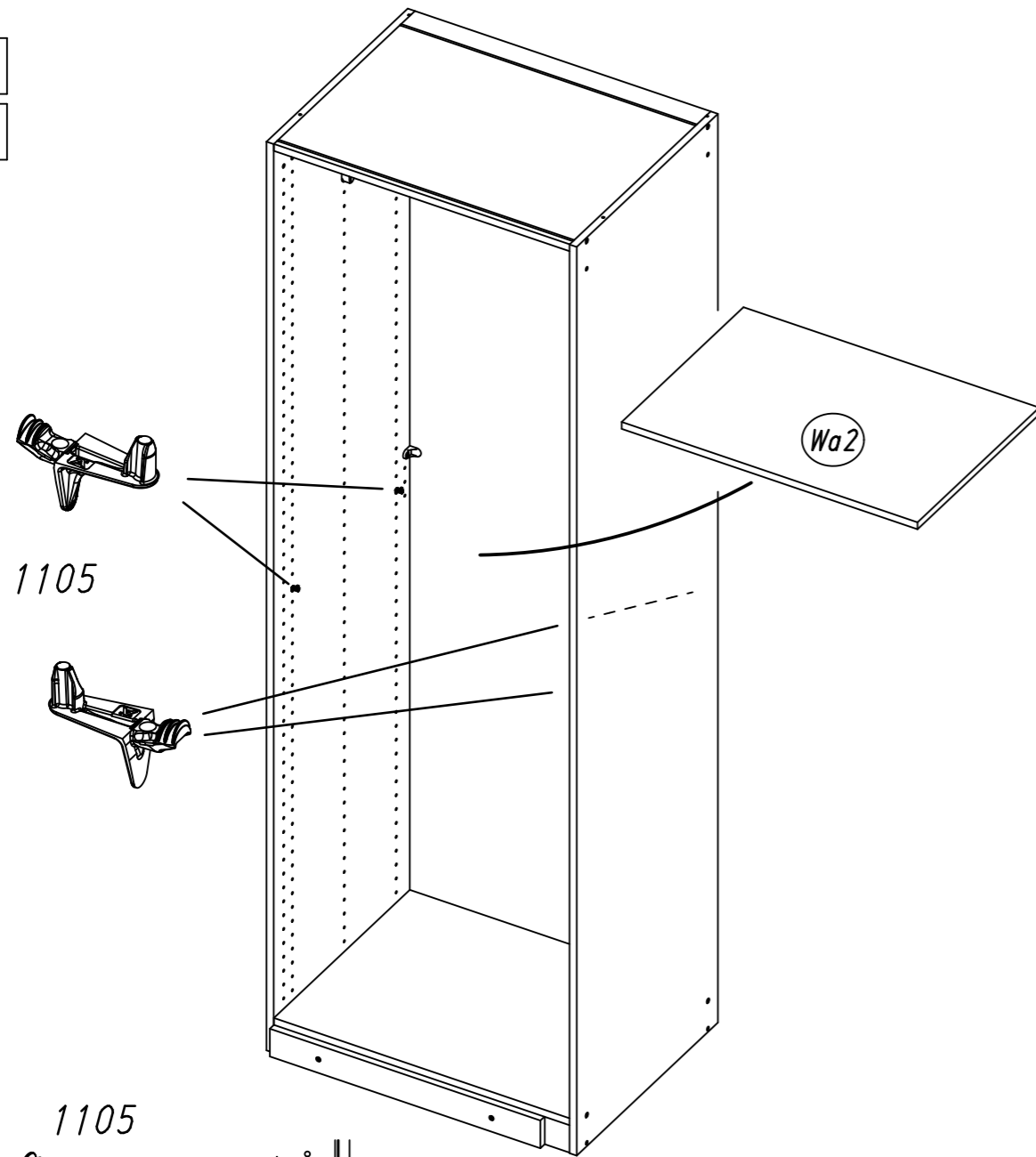

1105

Wa2

1105

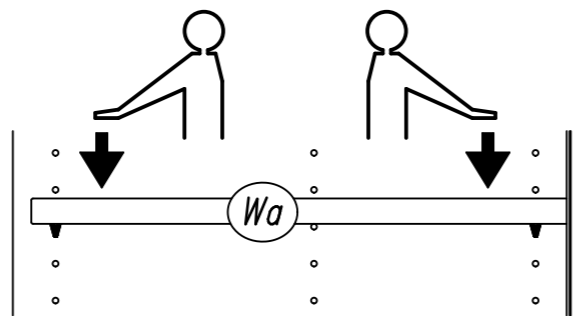
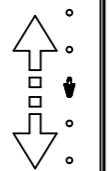
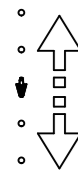

Wa

12

2x 209



4x45

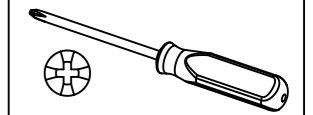

Typ I

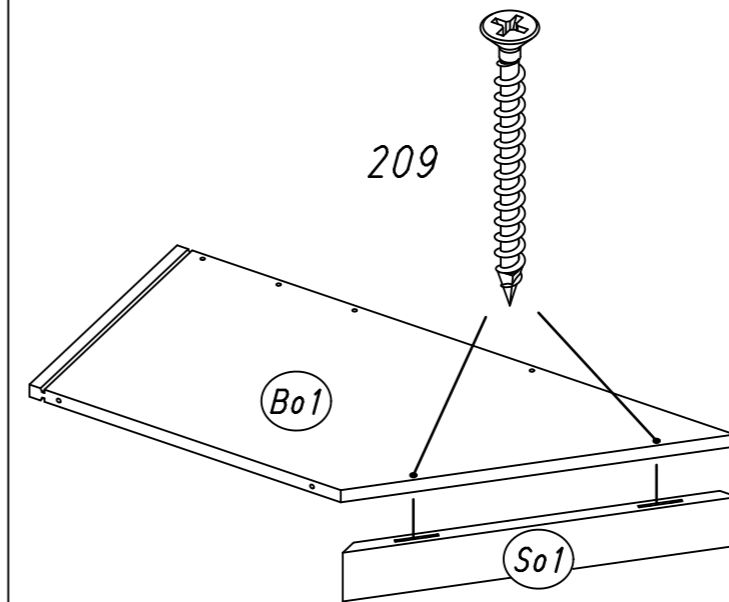

209

Bo1

So1

Bo1

So1

Typ II

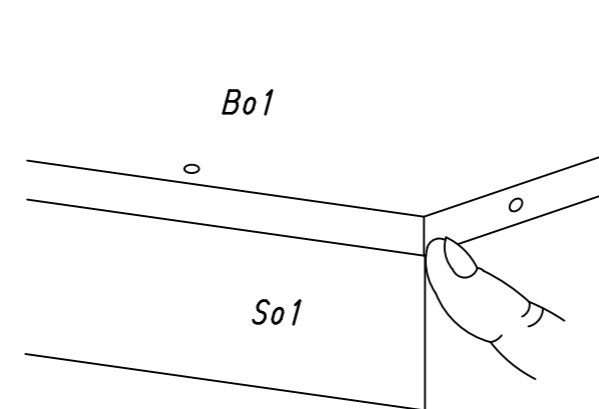

Bo1

So1

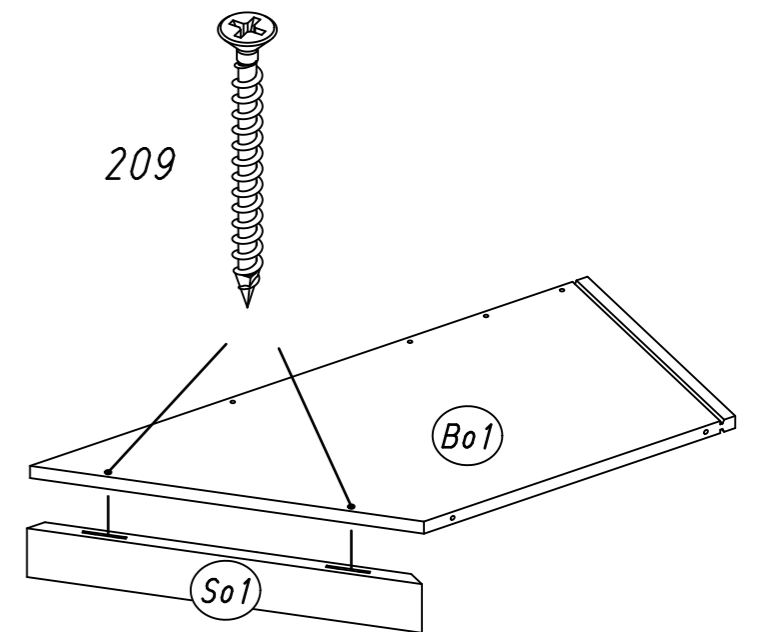

209

Bo1

So1

13

2x 209

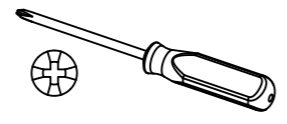
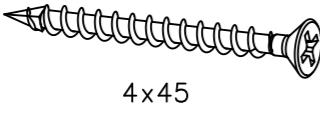

Typ I

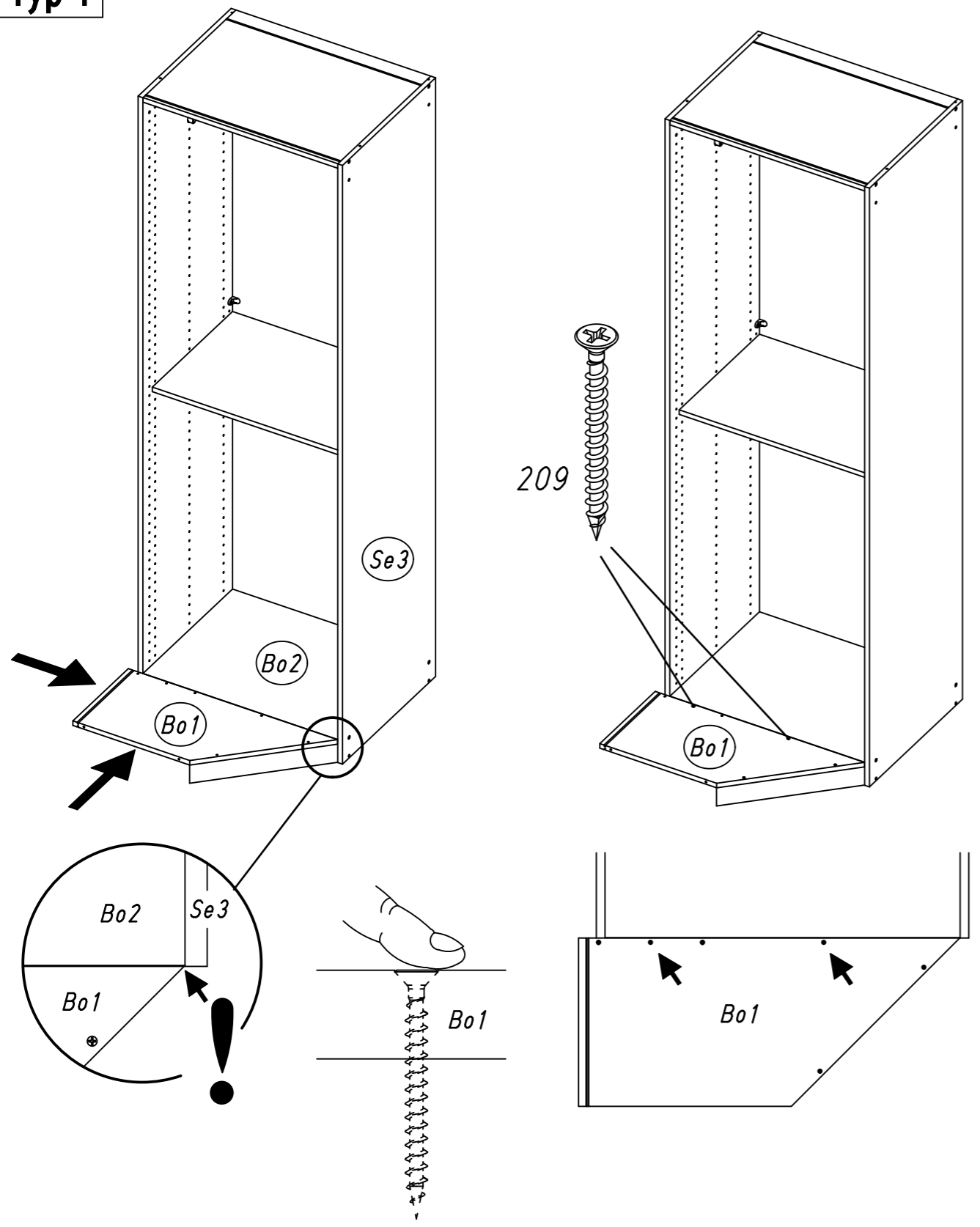

Typ II

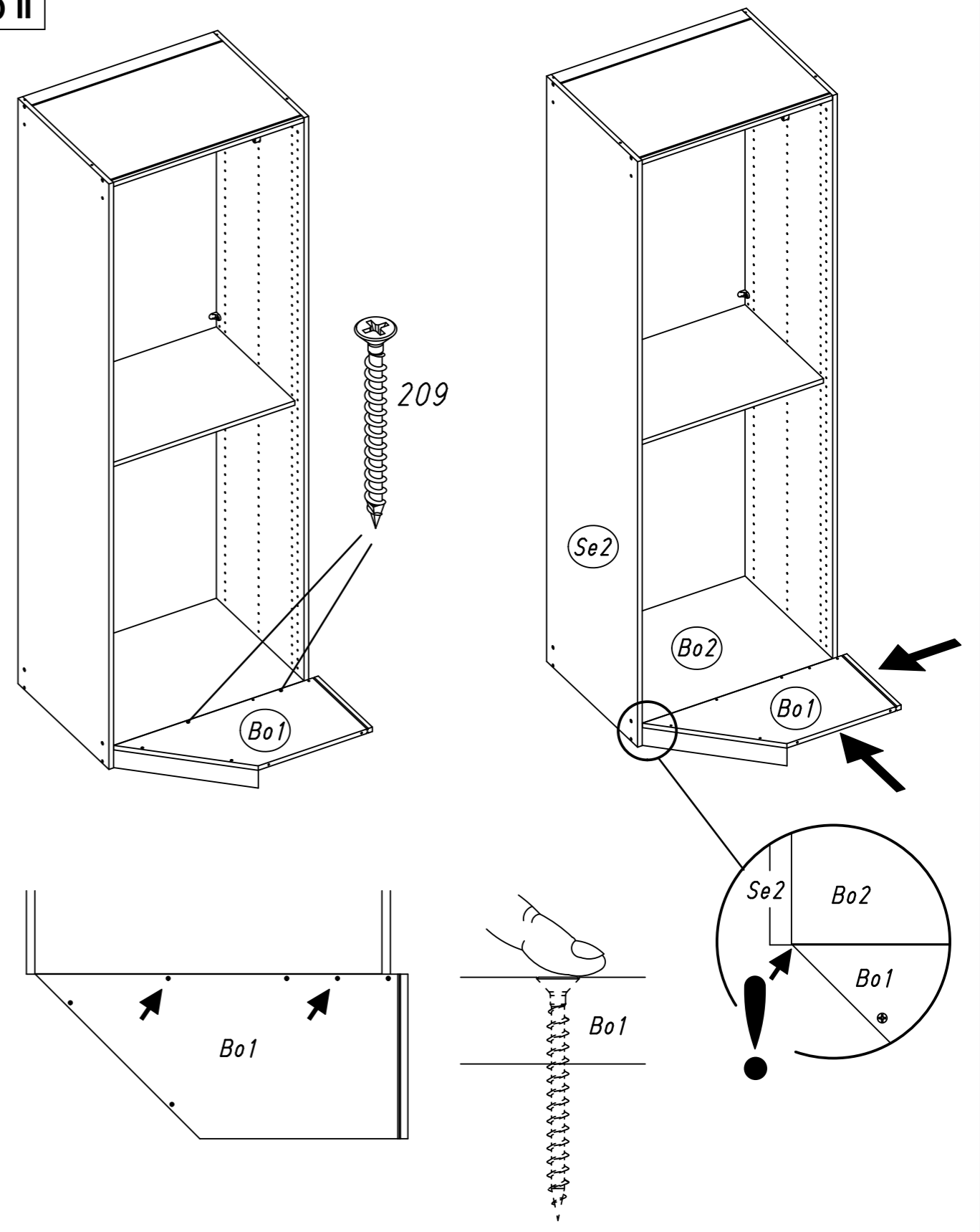

14

2x 183

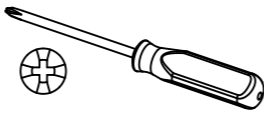
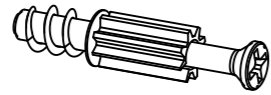

Typ I

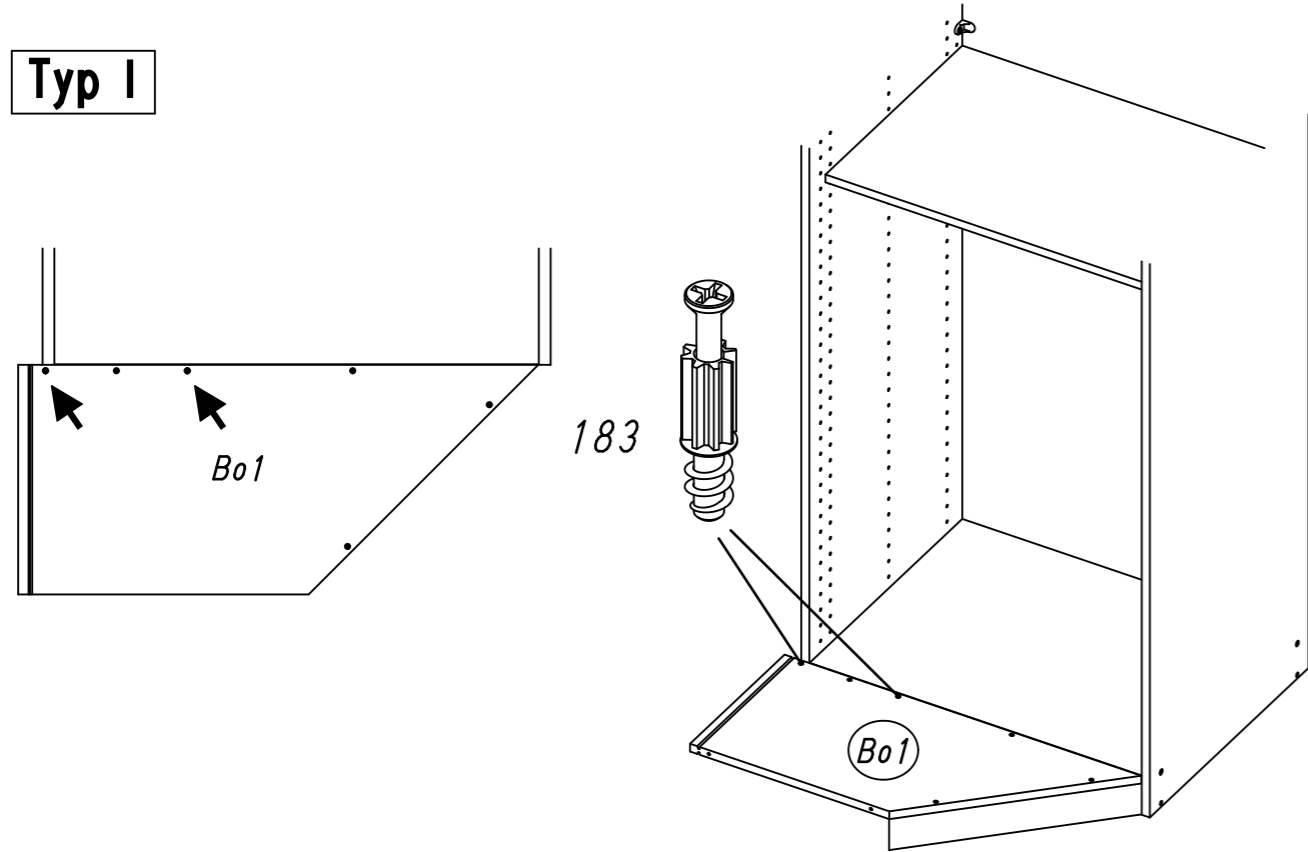

Typ II

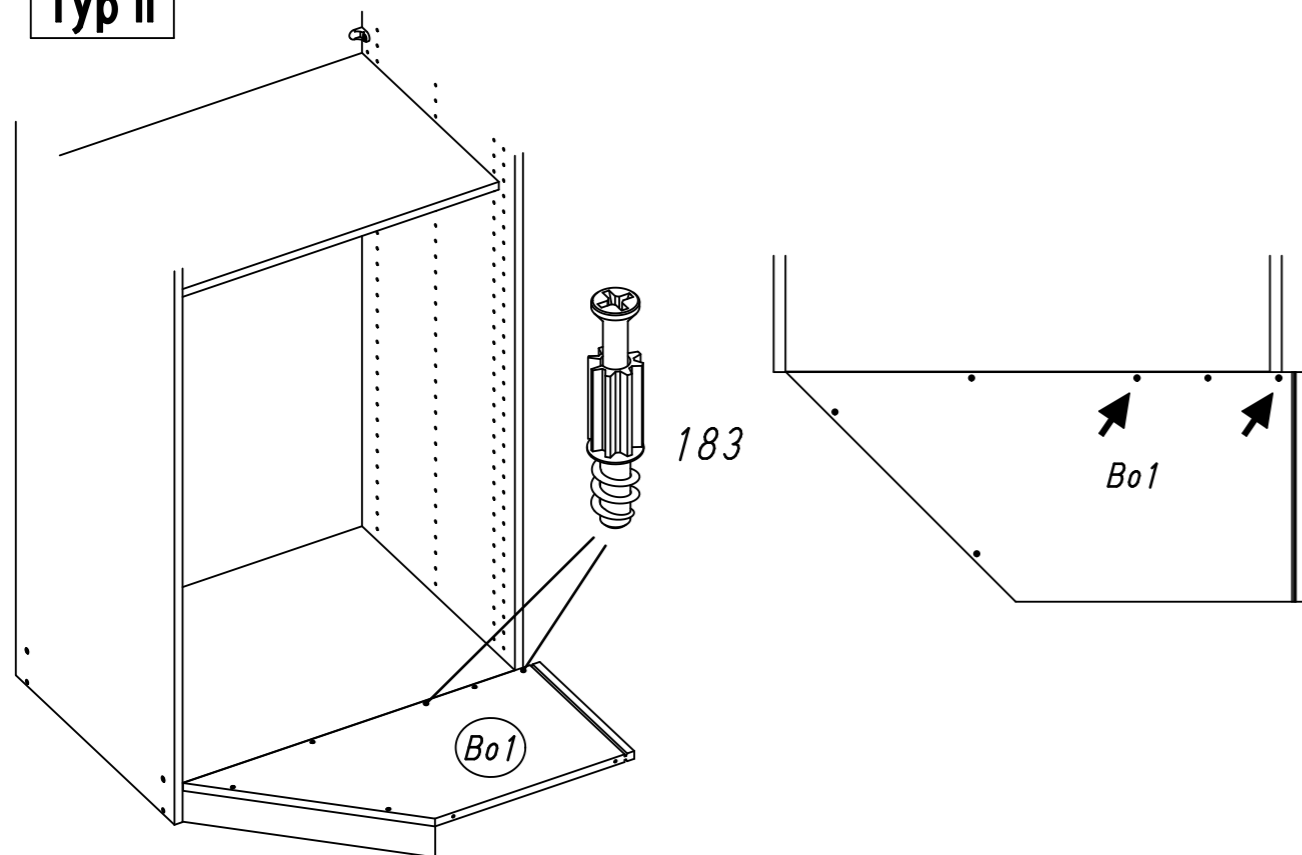

15

4x 349



Typ I

Typ II

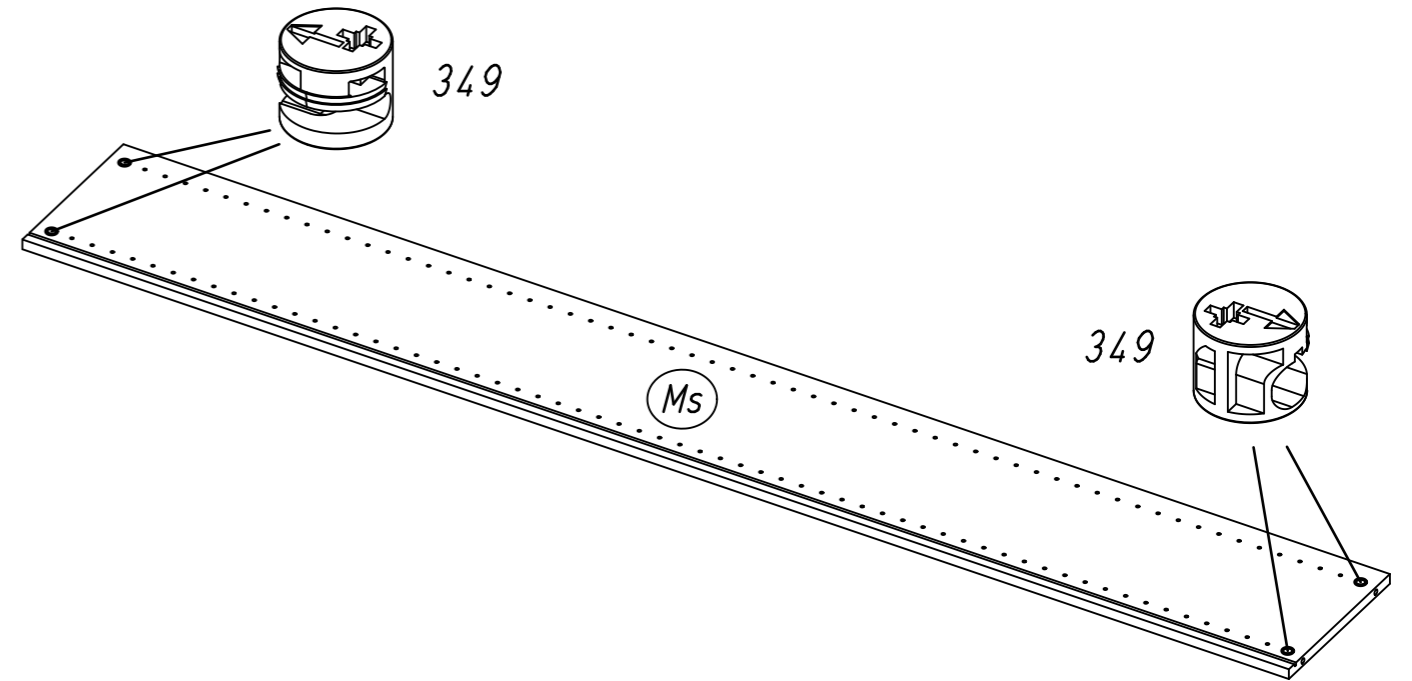

16

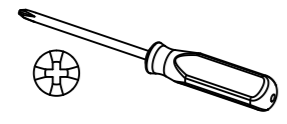

Typ I

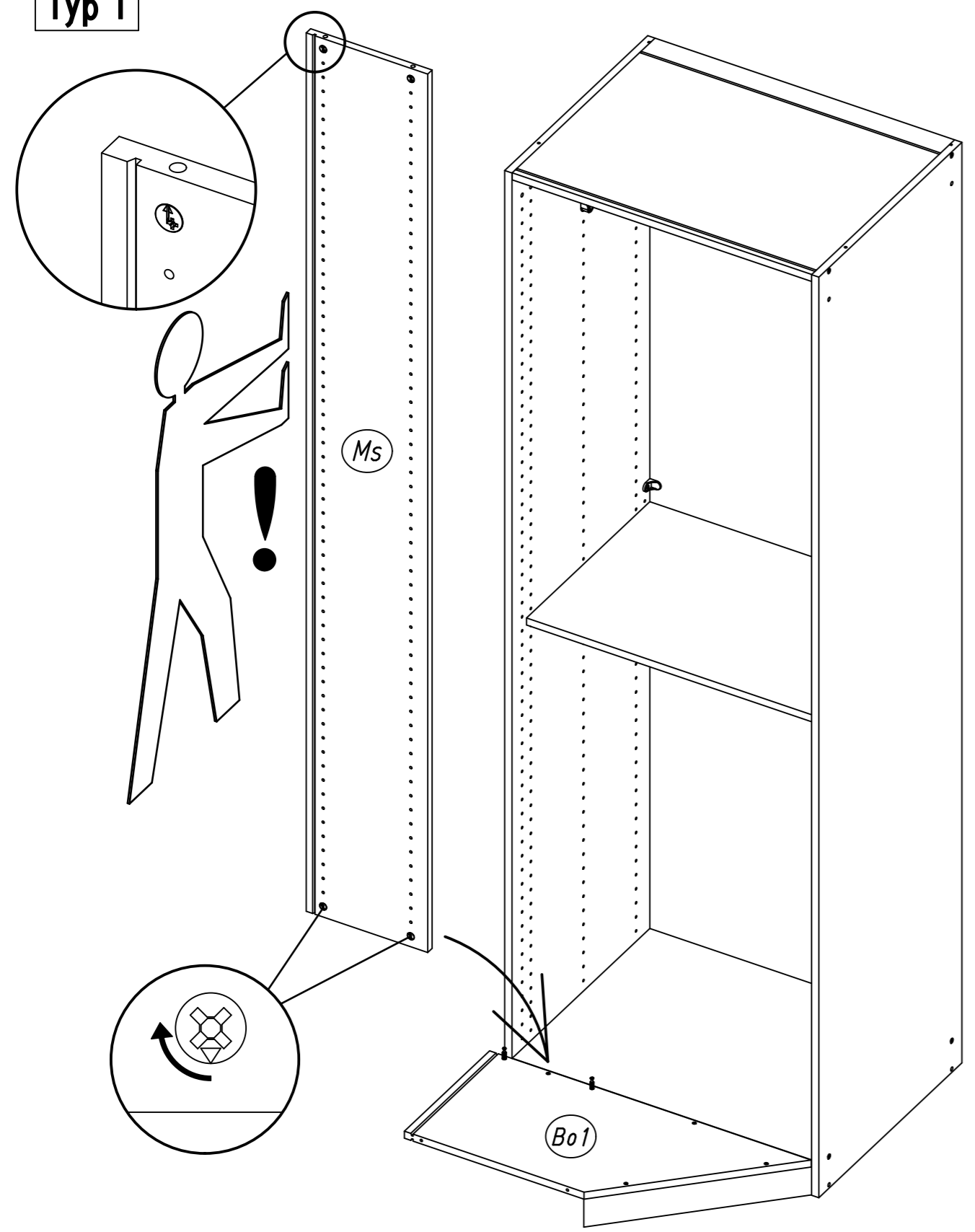

Typ II

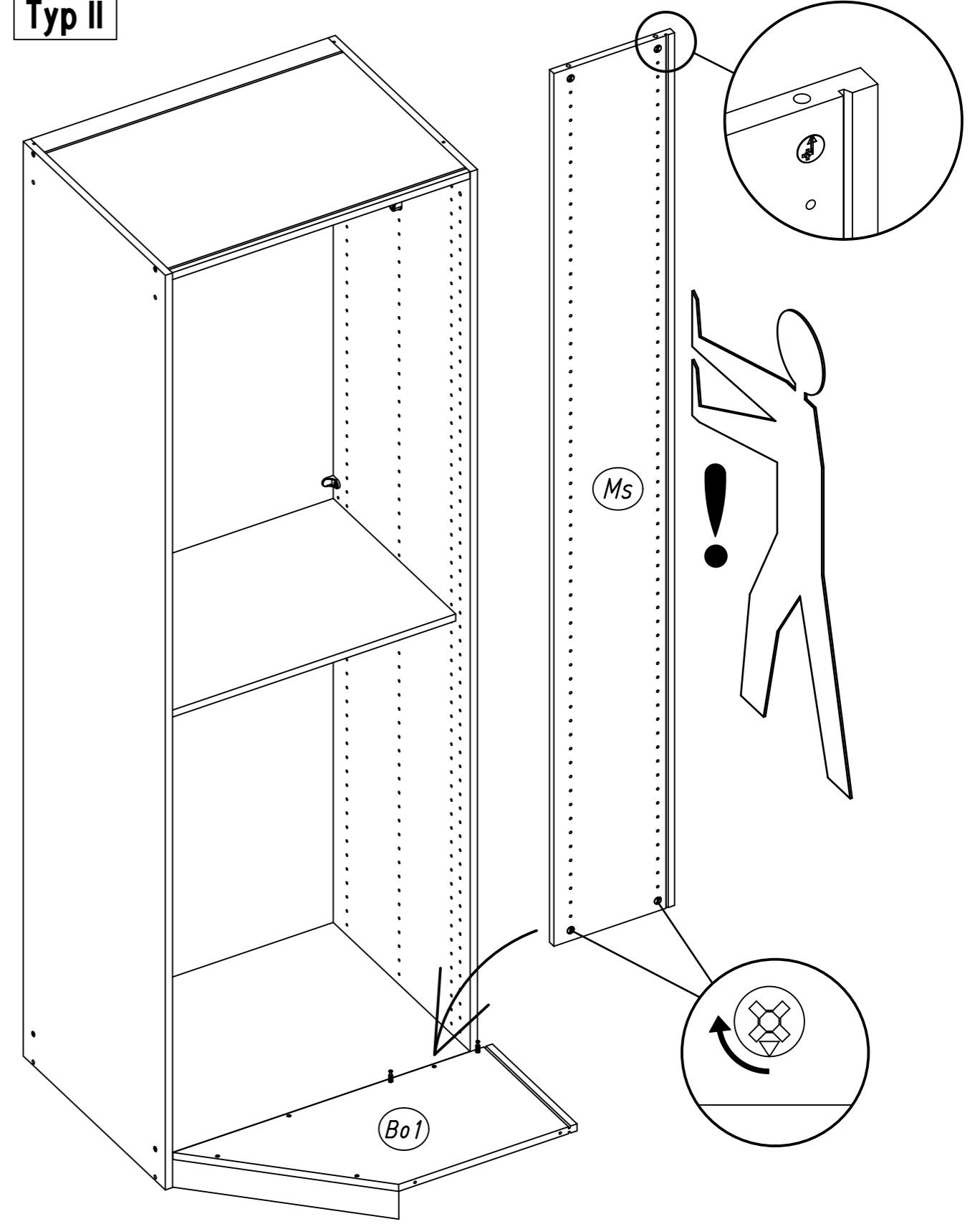

17

1x 1

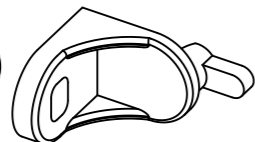

1x 779

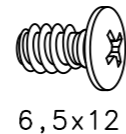

6,5x12

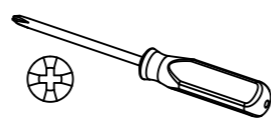

Typ I

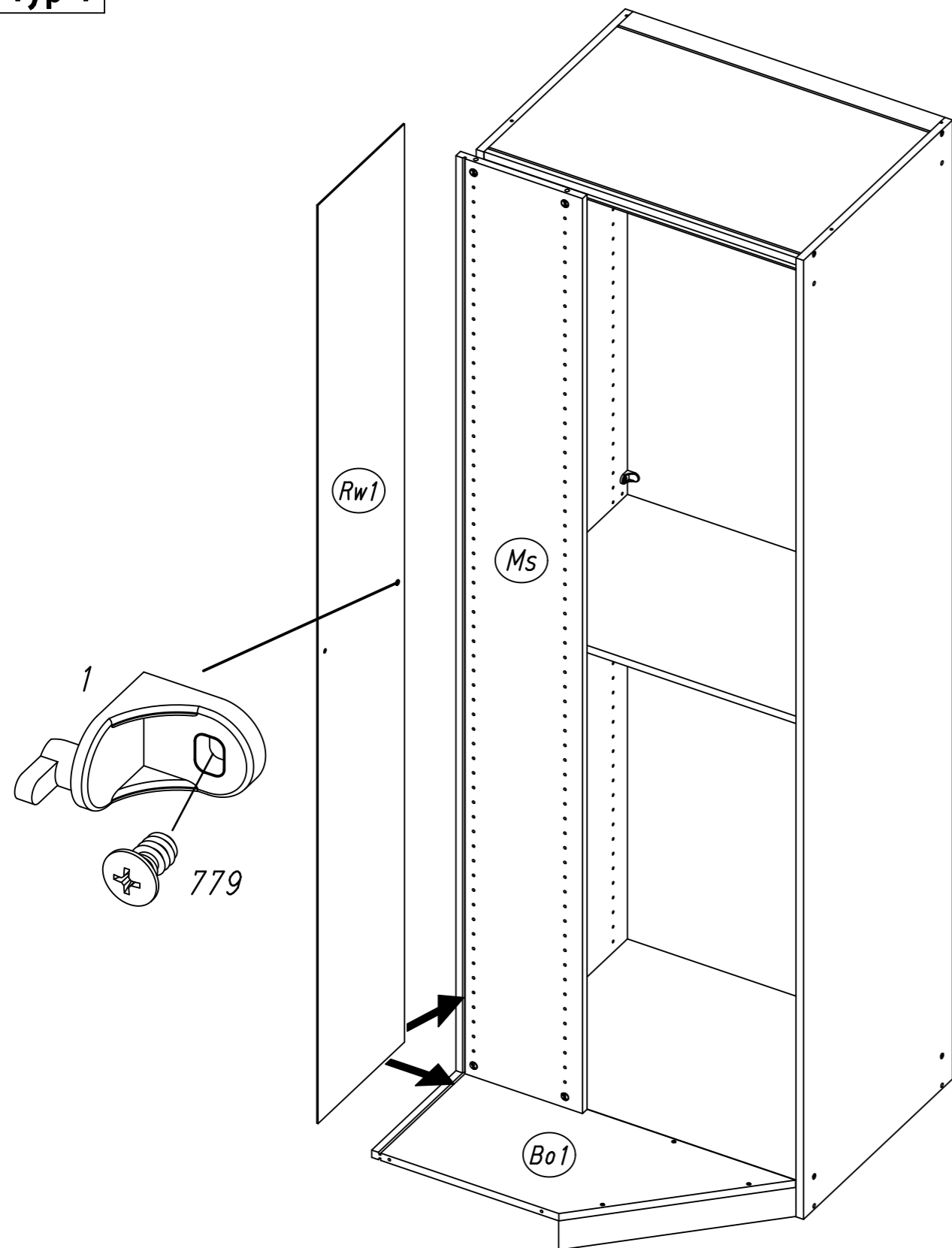

Typ II

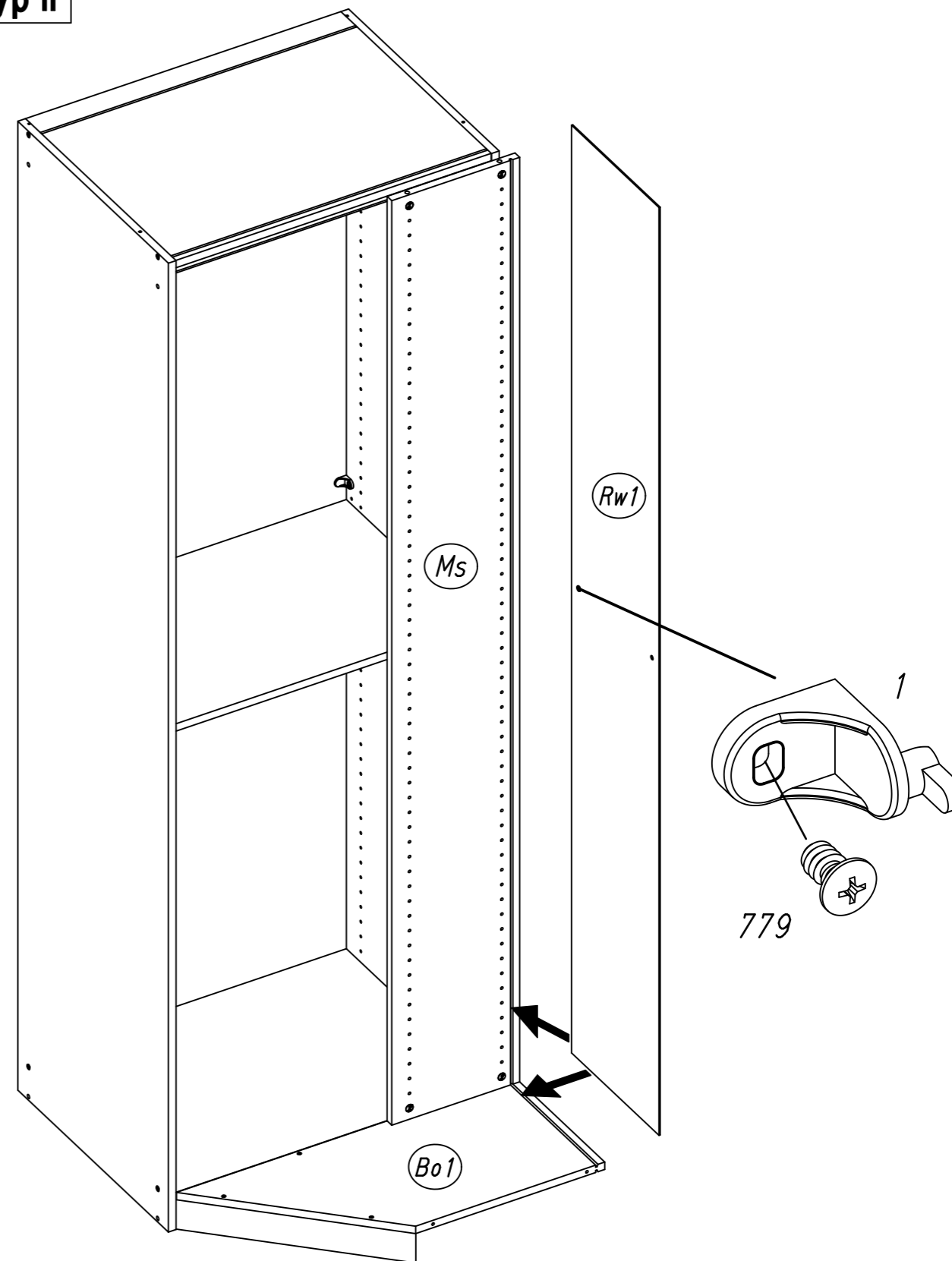

18

2x

174

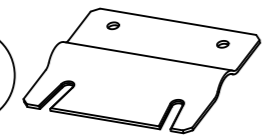

4x

202



4,5x16

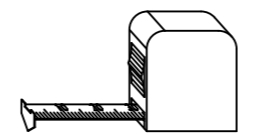
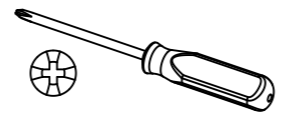

Typ I

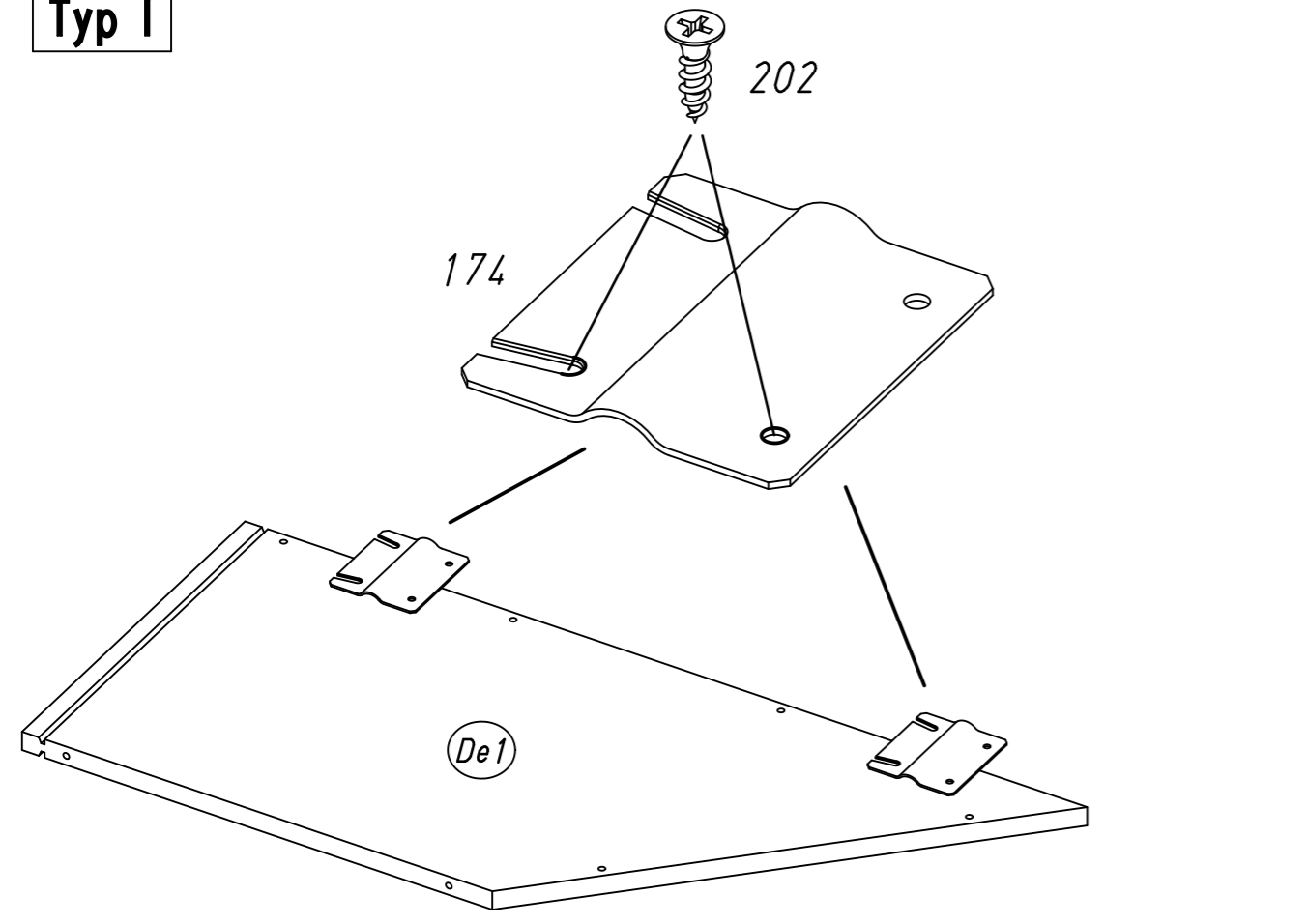

Typ II

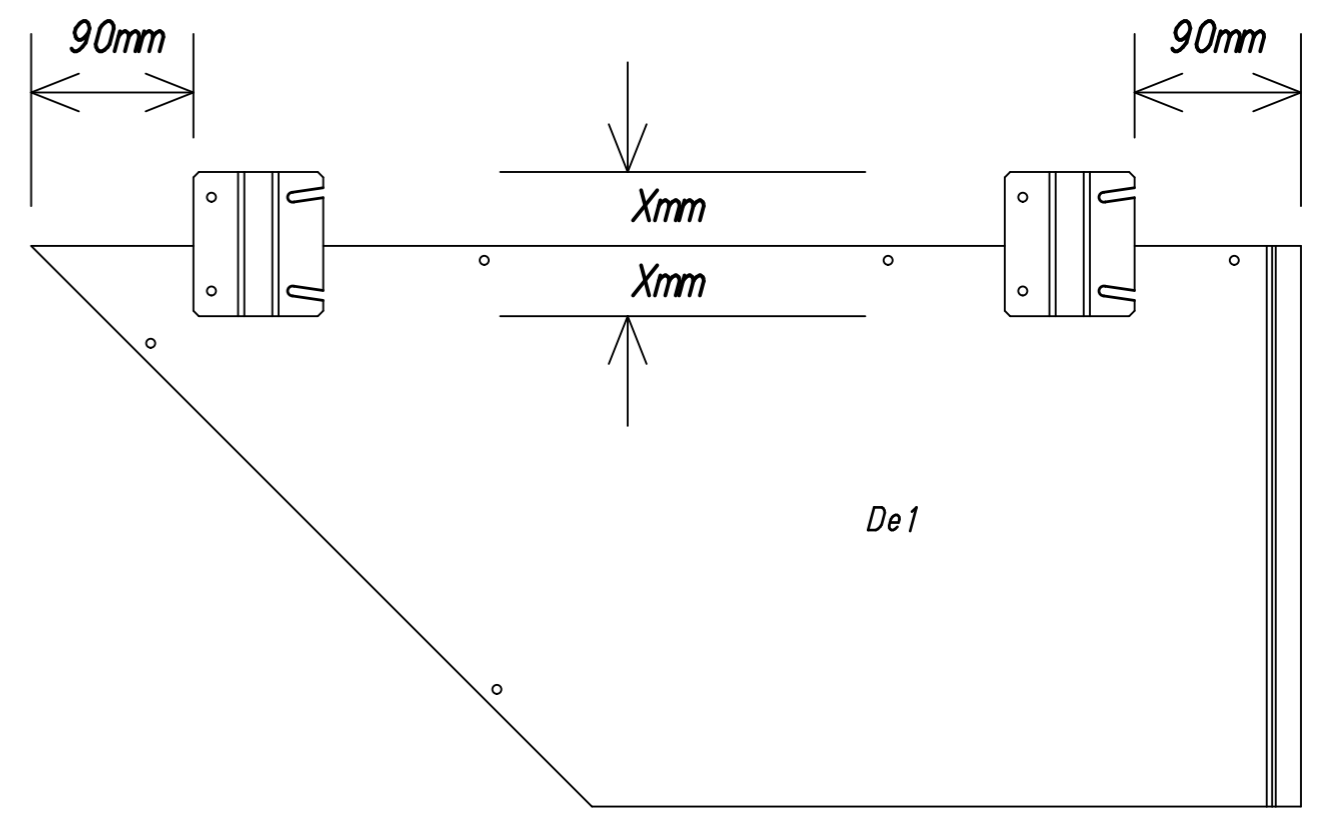
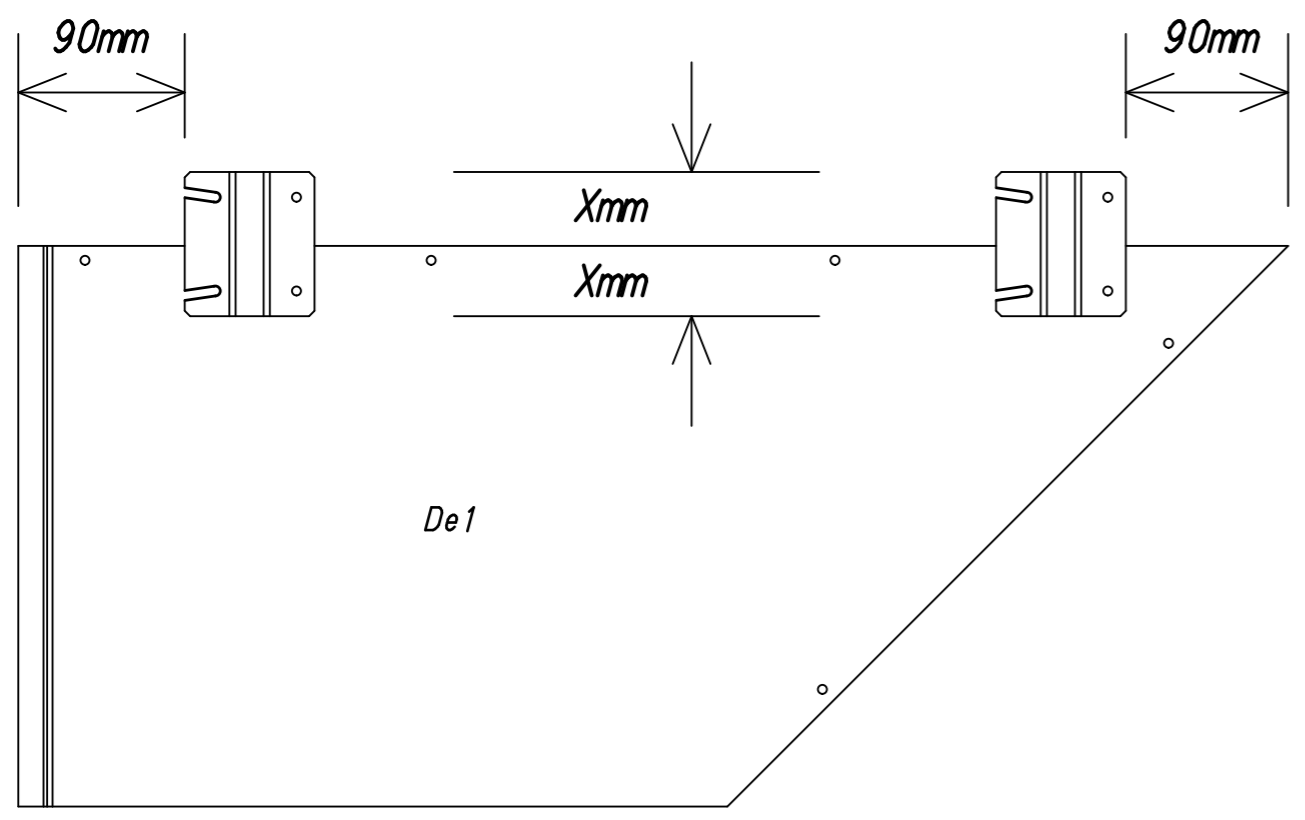
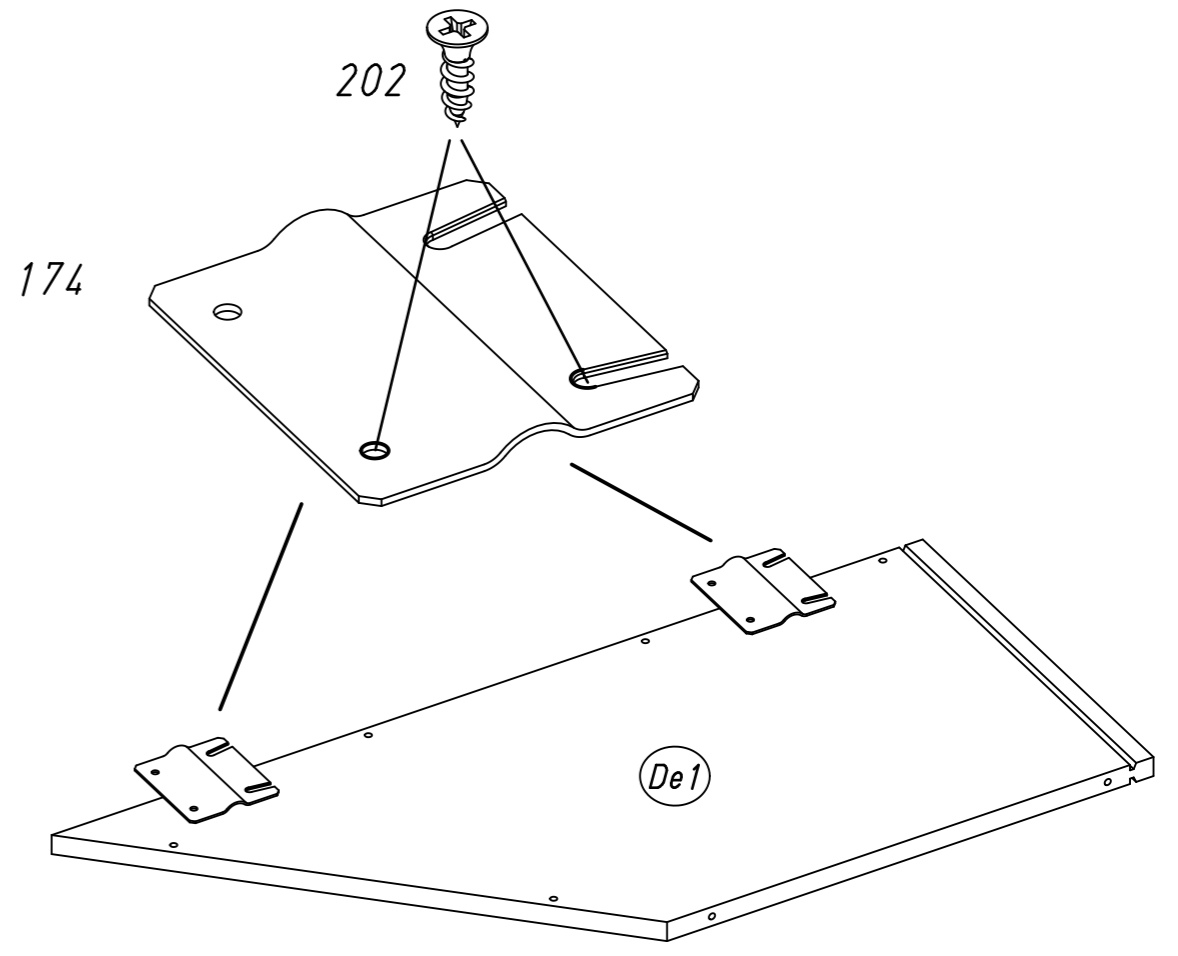

19

2x 183

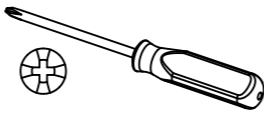
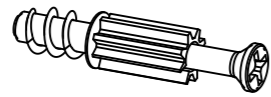

Typ I

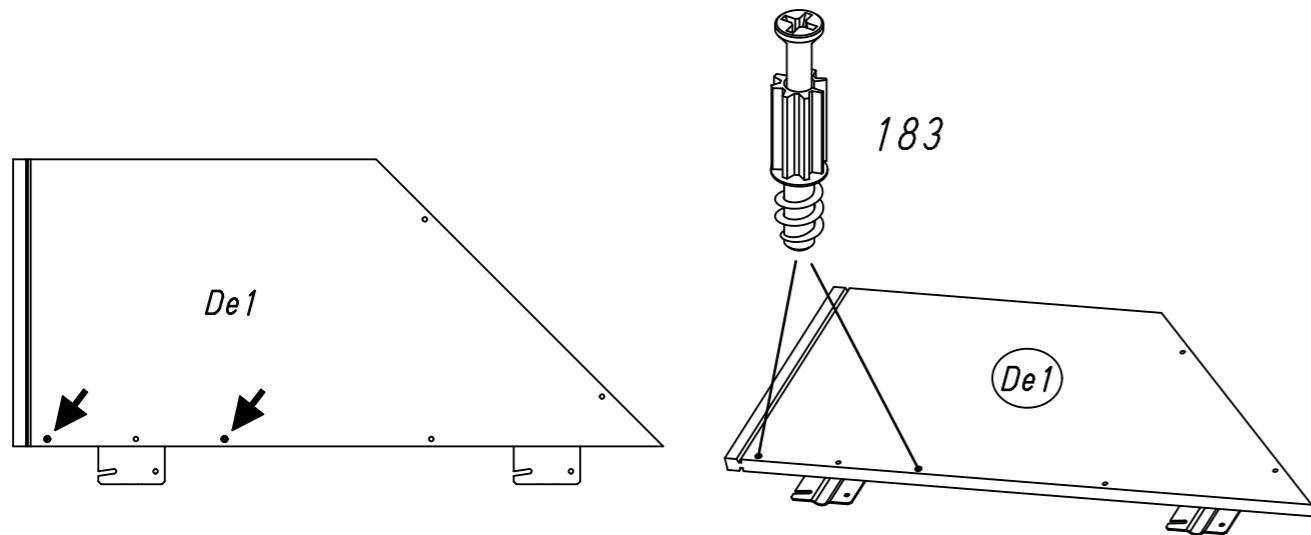

Typ II

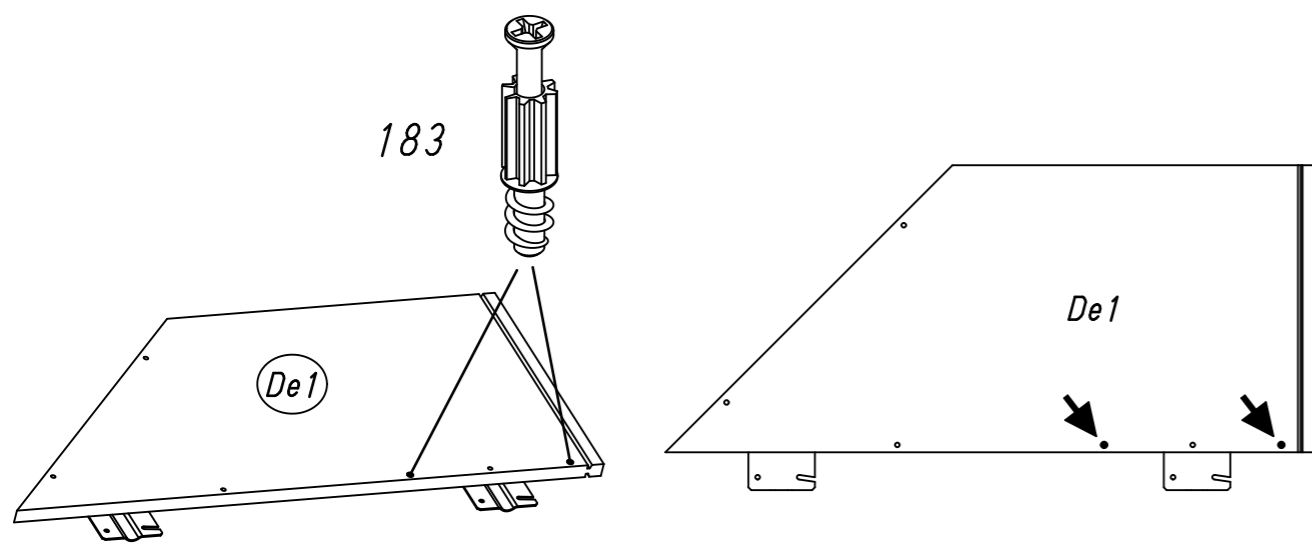

20

4x 202

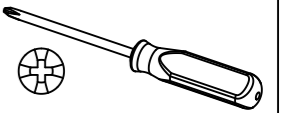
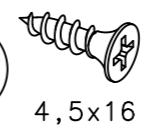

Typ I

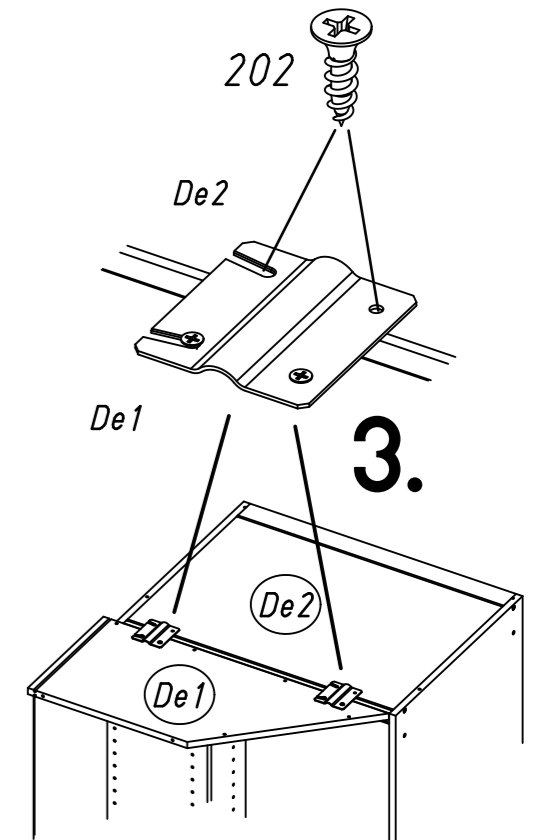
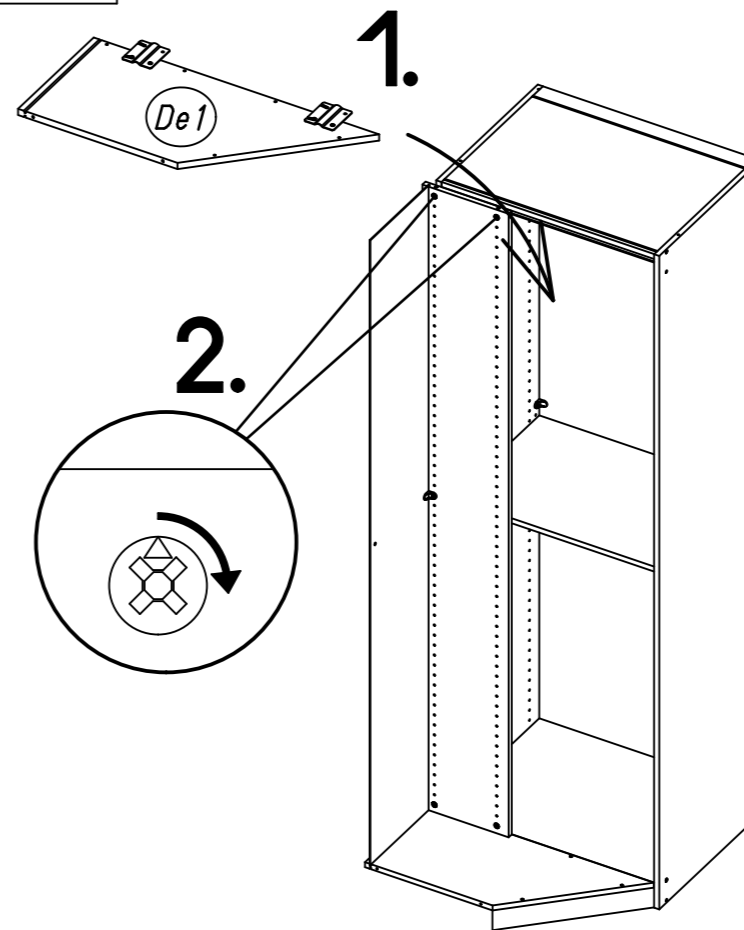

Typ II

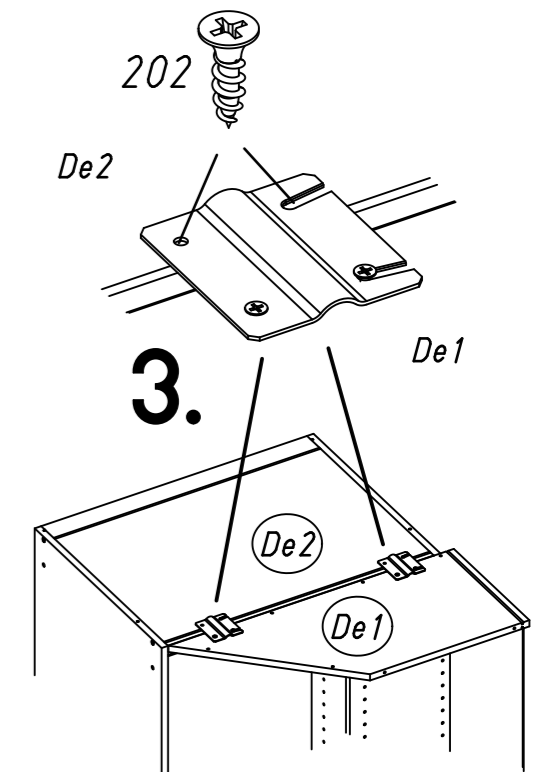
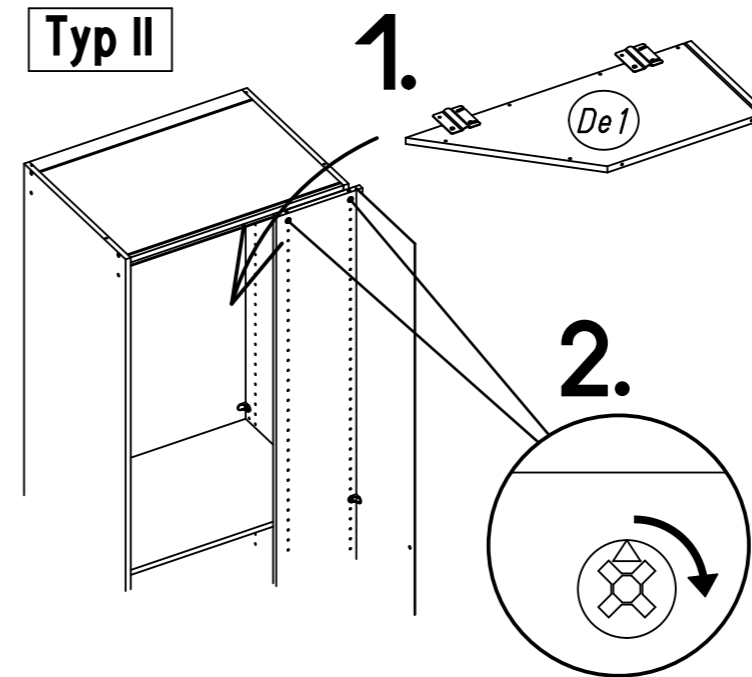

21

1x 133

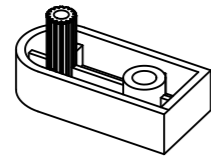

1x 427

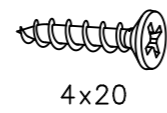

4x20

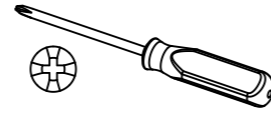

Typ I

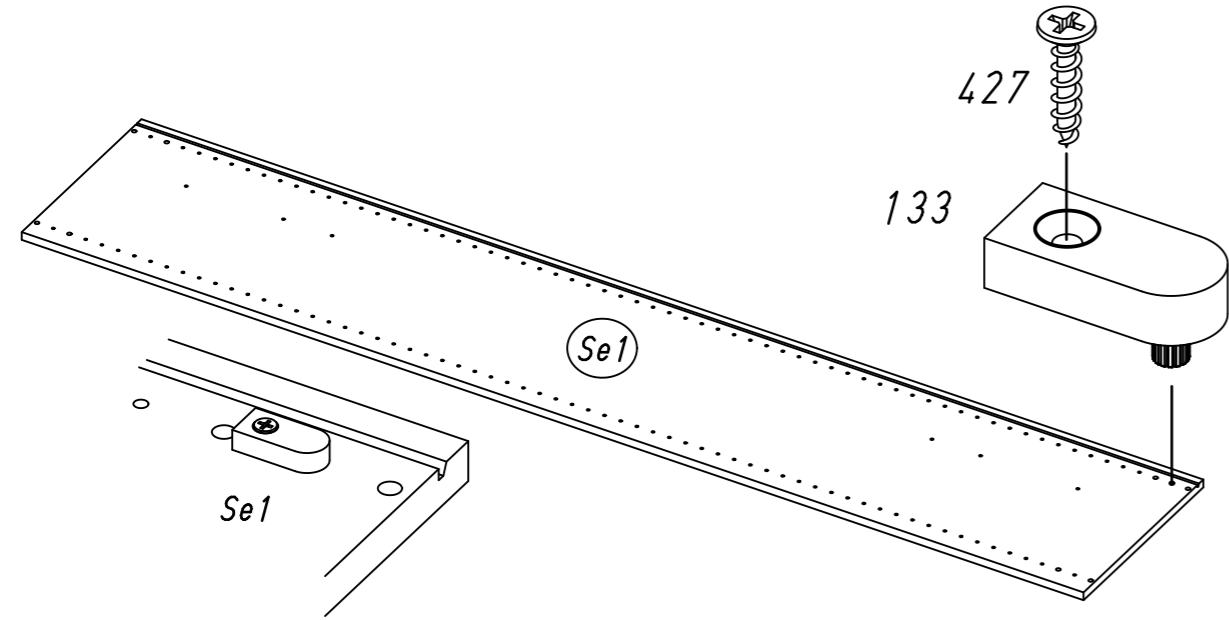

Typ II

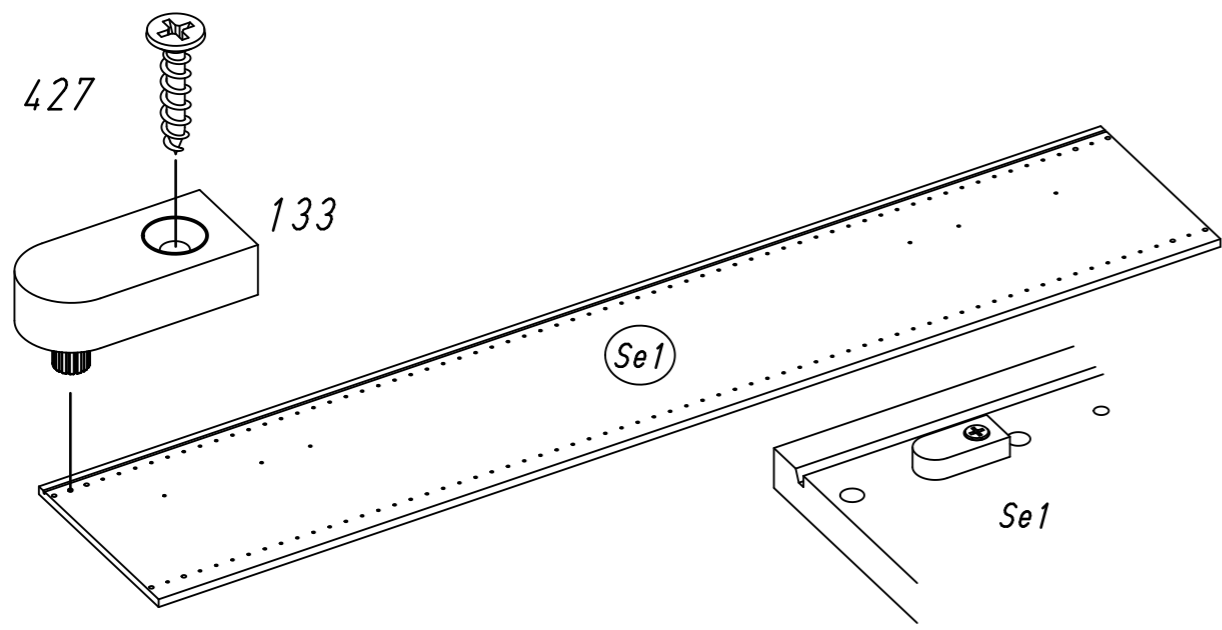

22

4x 233

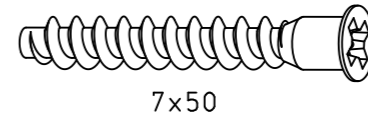

7x50

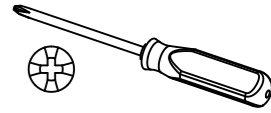

Typ I

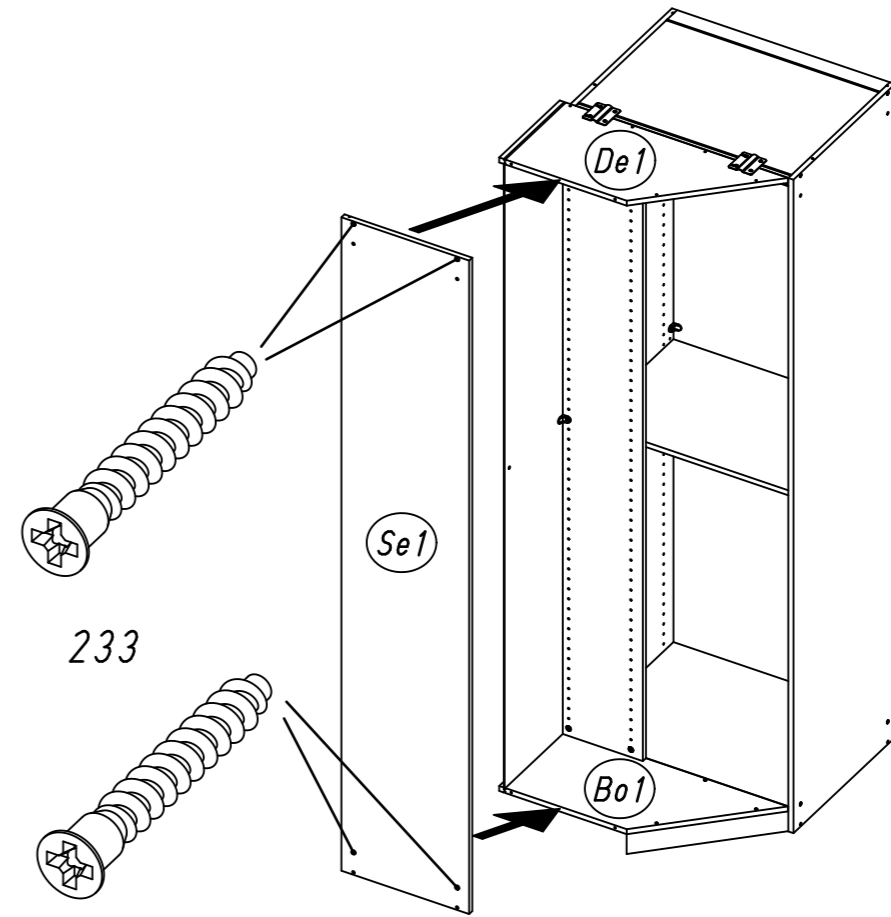

Typ II

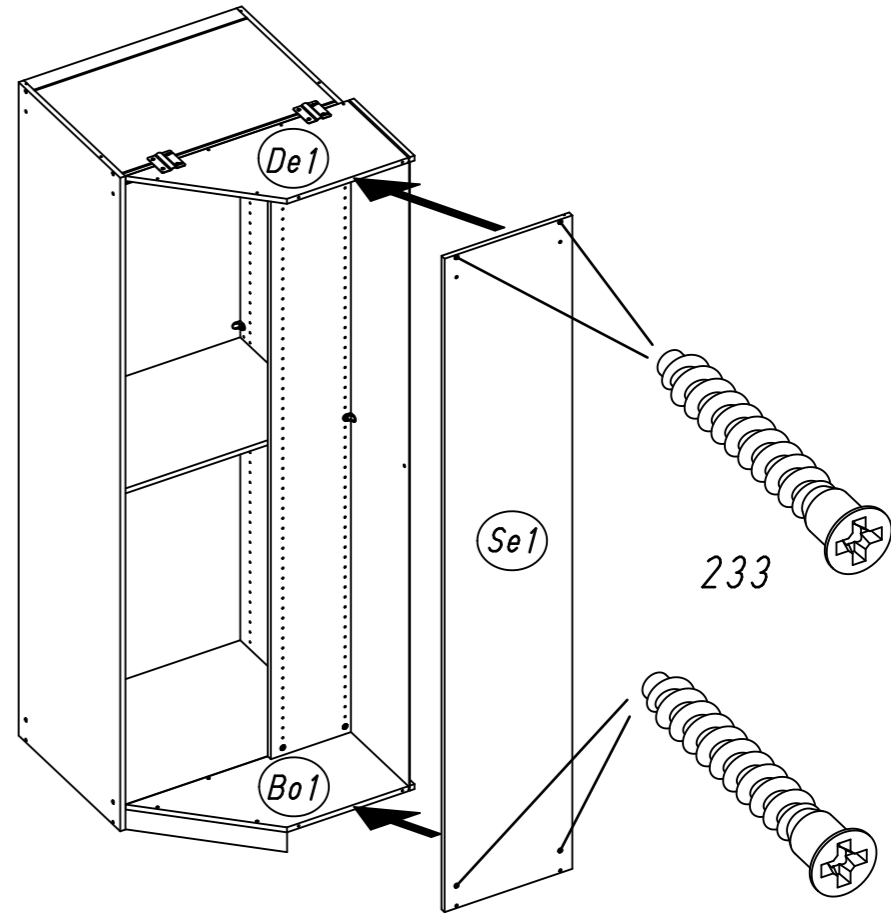

23

1x 1

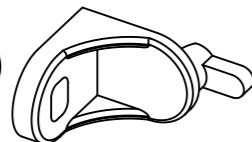

1x 779



6,5x12

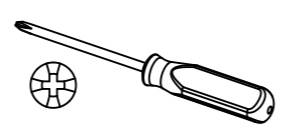

Typ I

Typ II

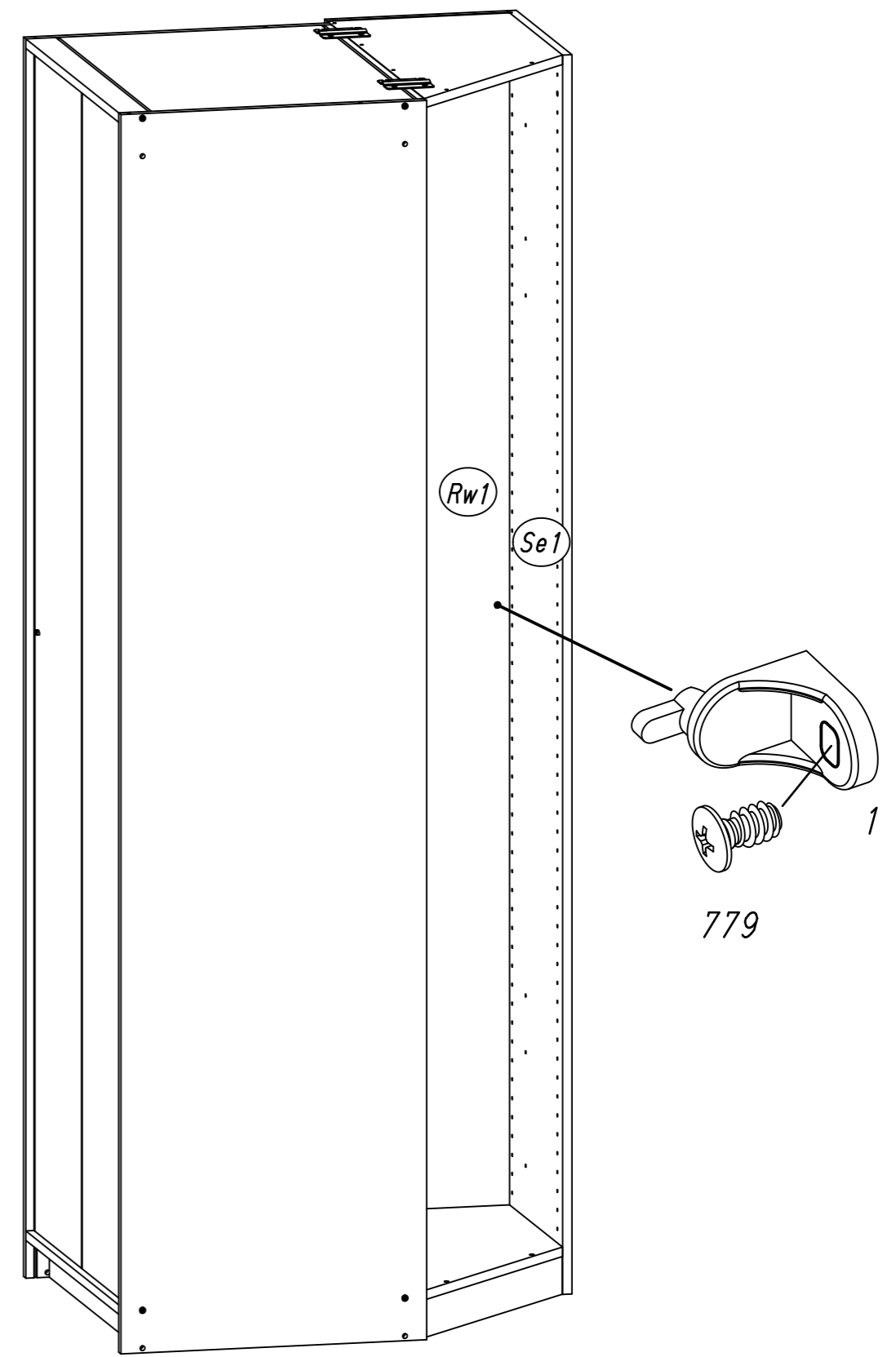
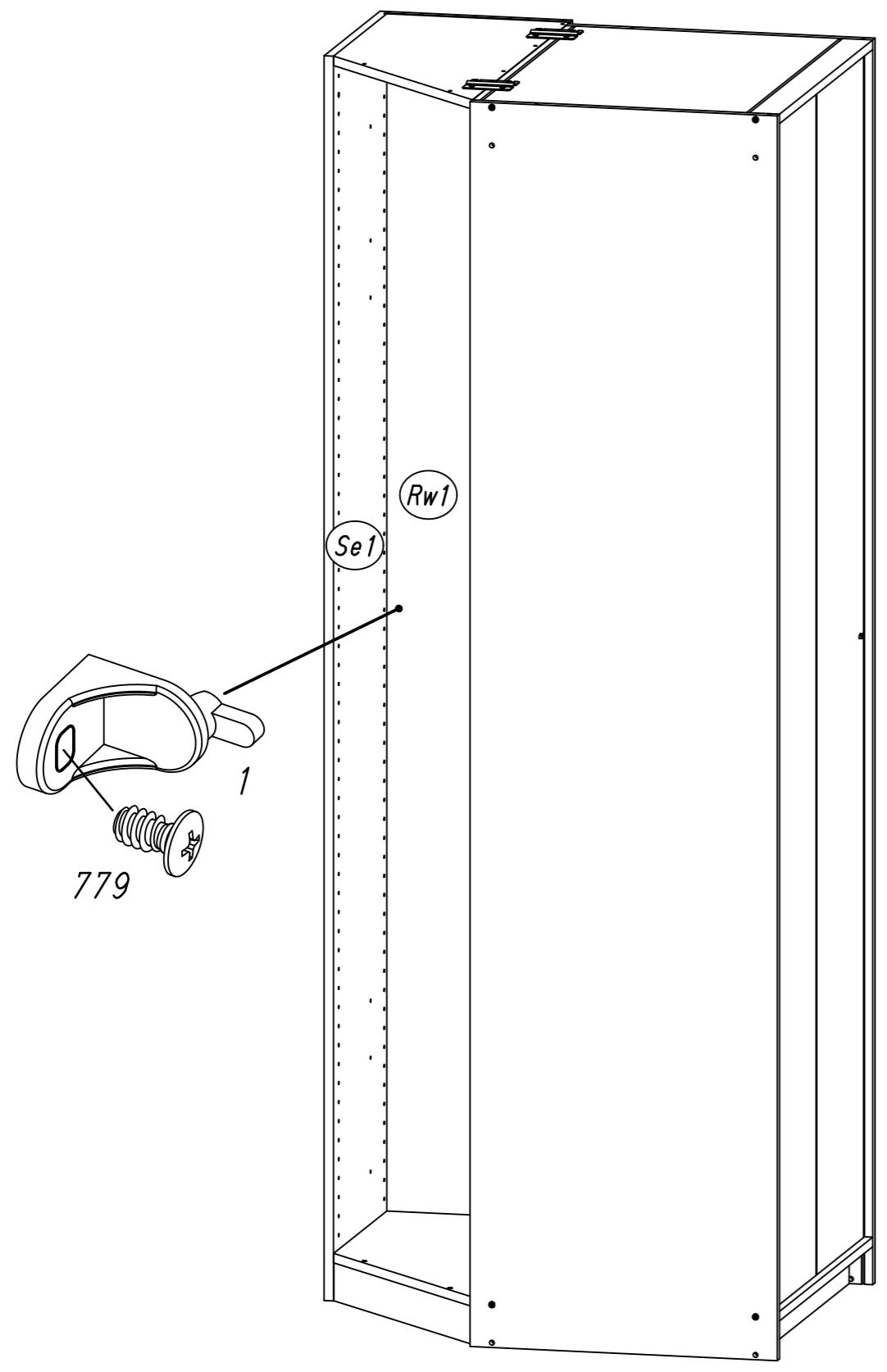

24

4x 1105

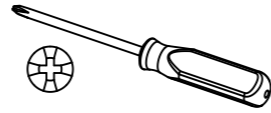
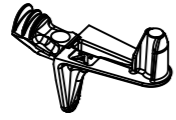

Typ I

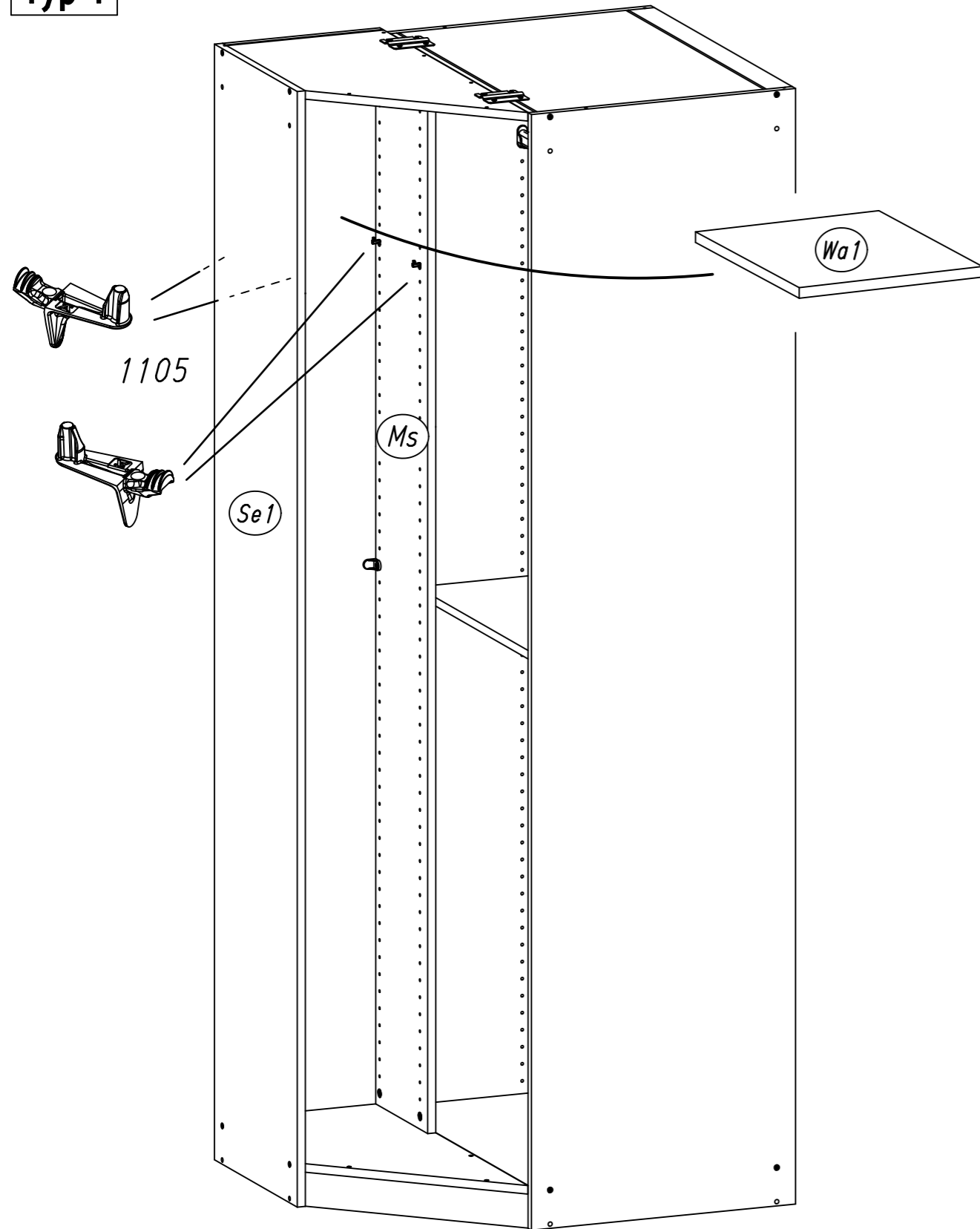

Typ II

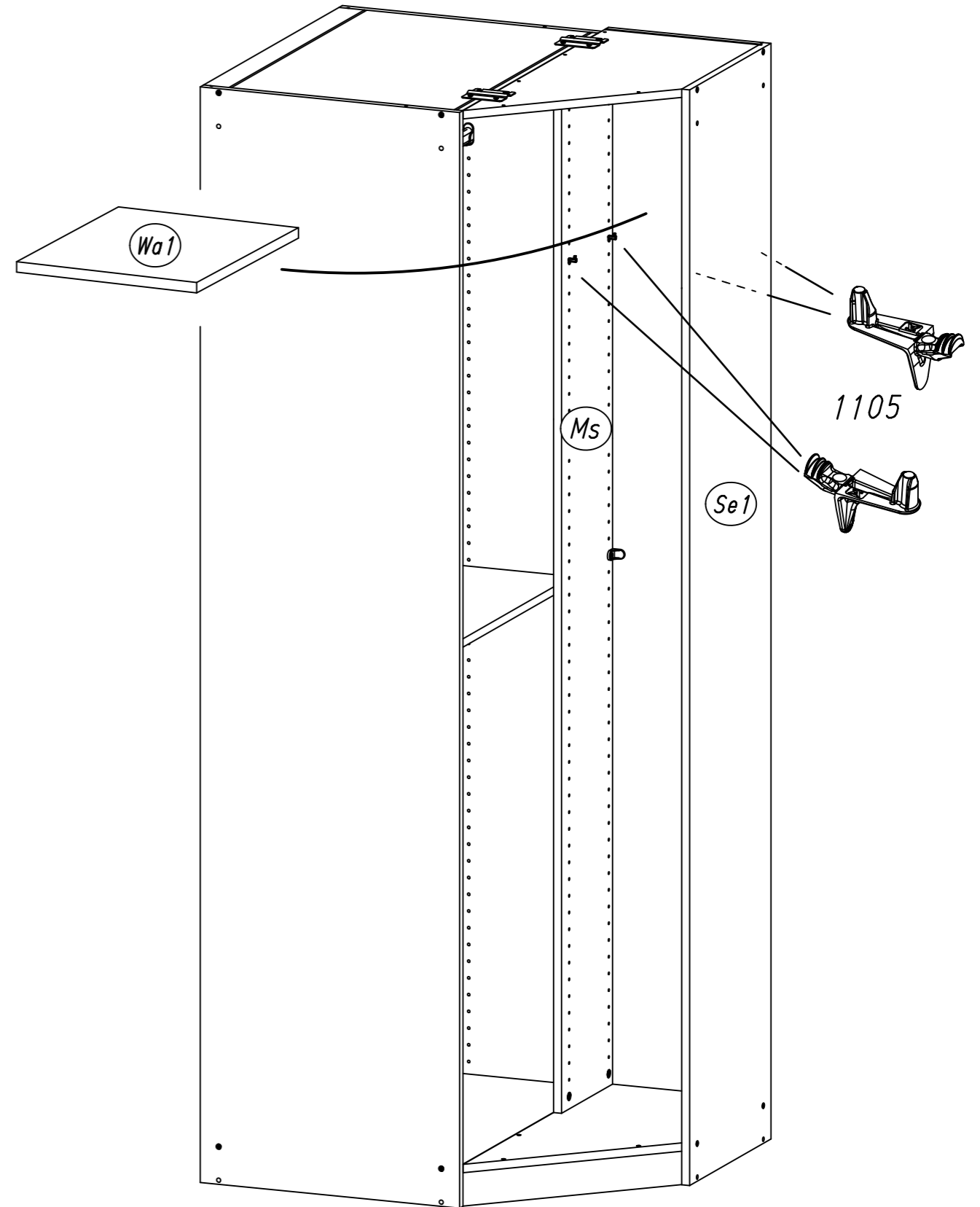

25

1x 806



2x 205

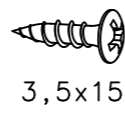

3,5x15

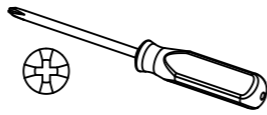

Typ I

Typ II

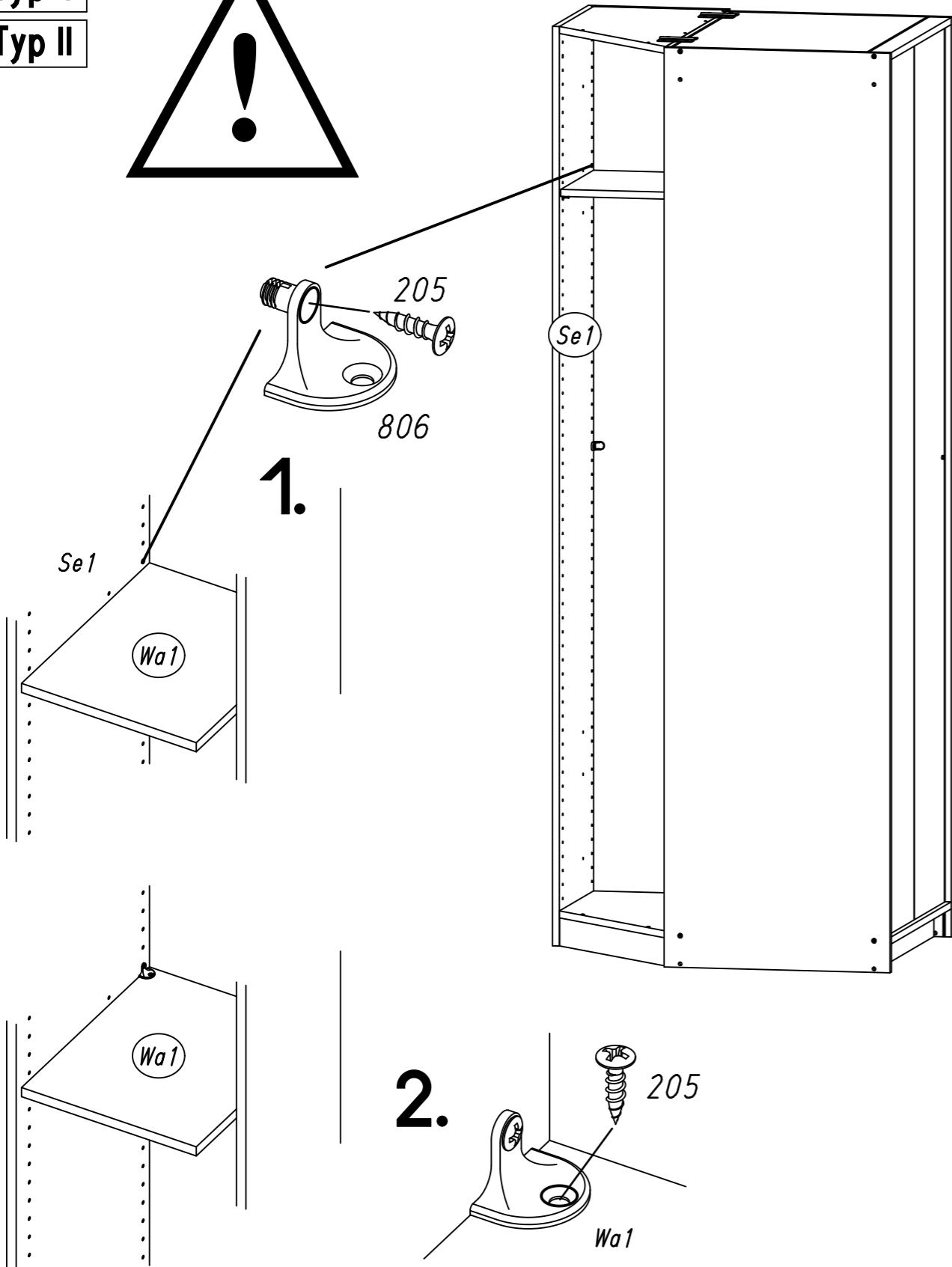

26

3x 12

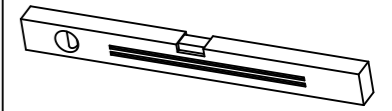
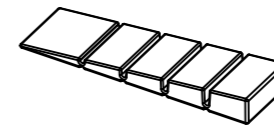

Typ I

Typ II

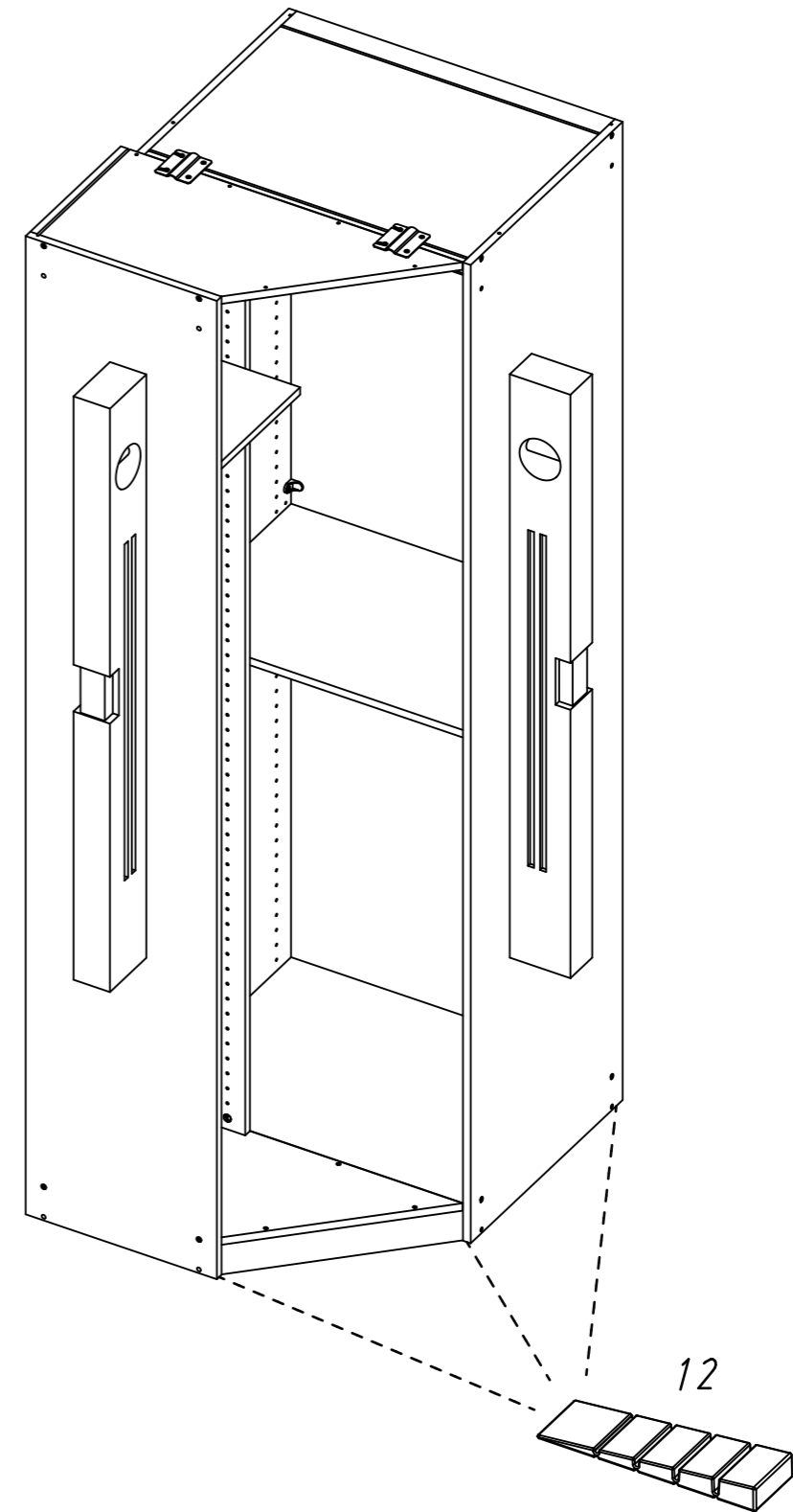

27

4x 45

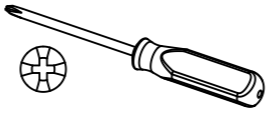
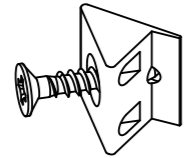

Typ I

Typ II

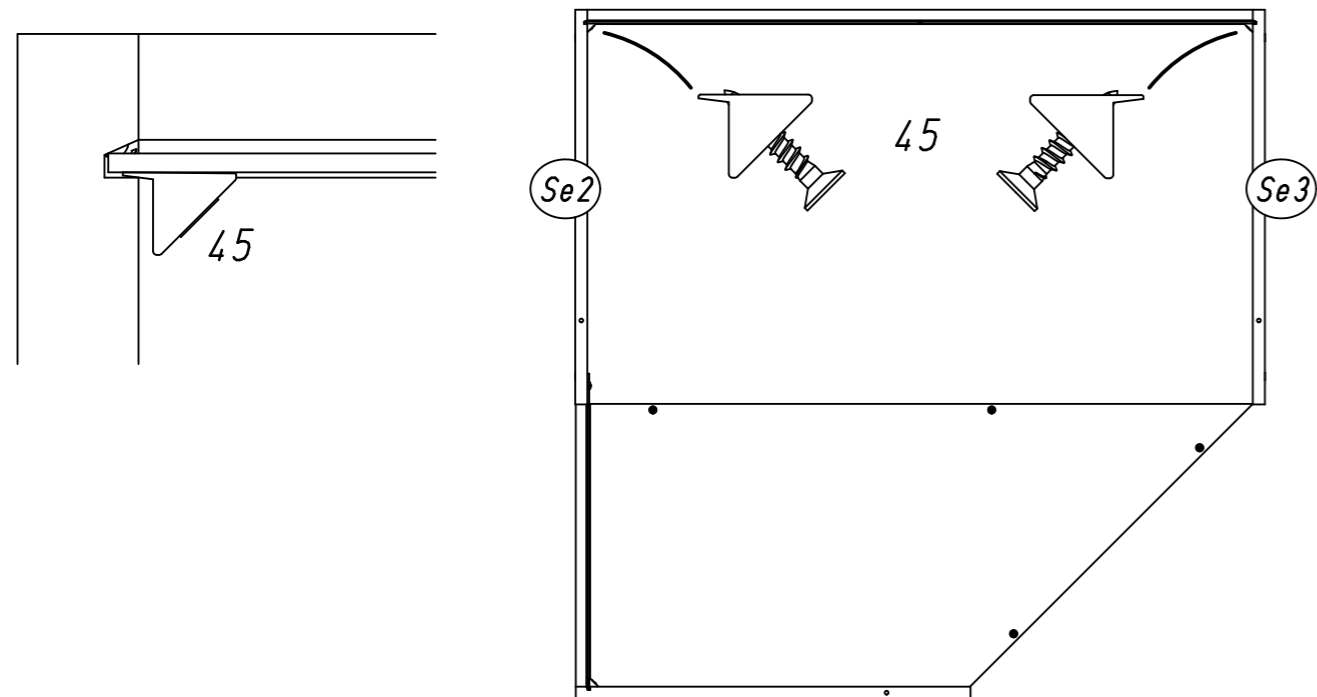
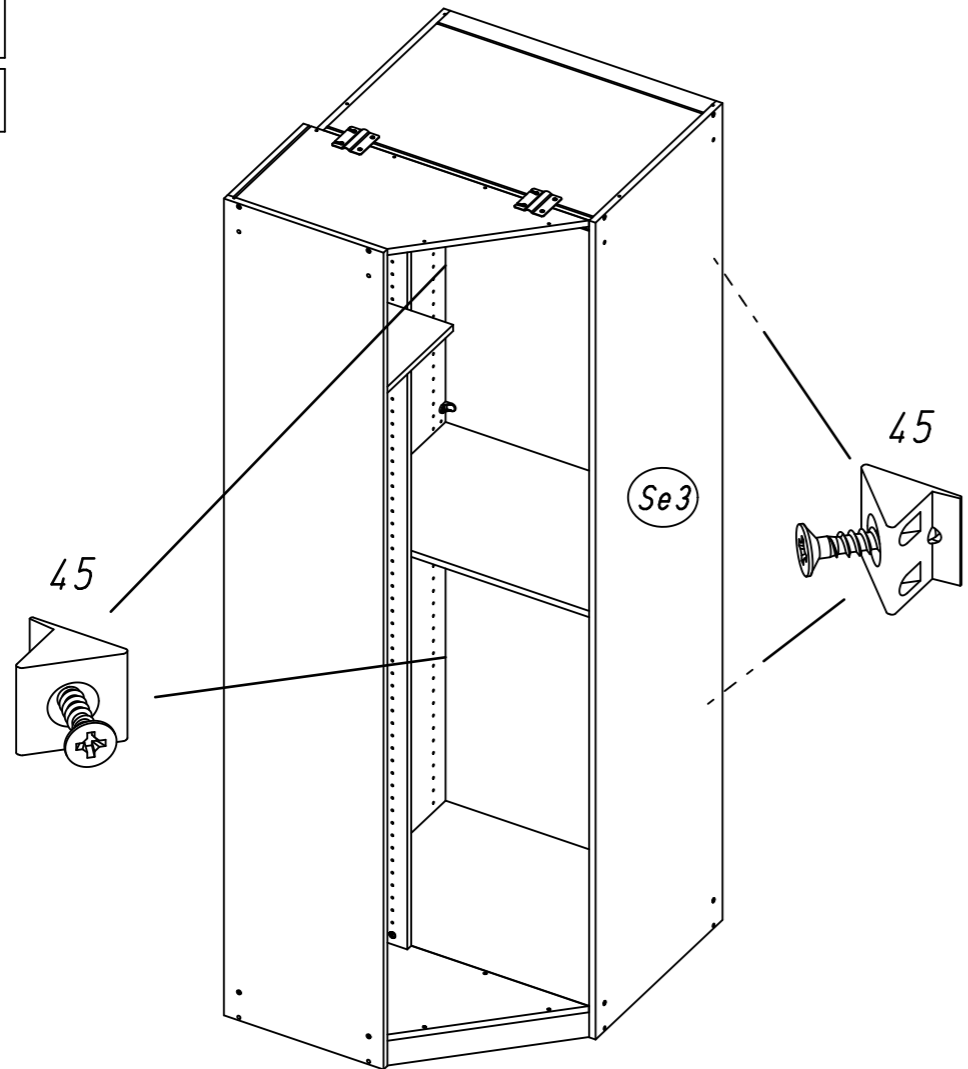

28

125

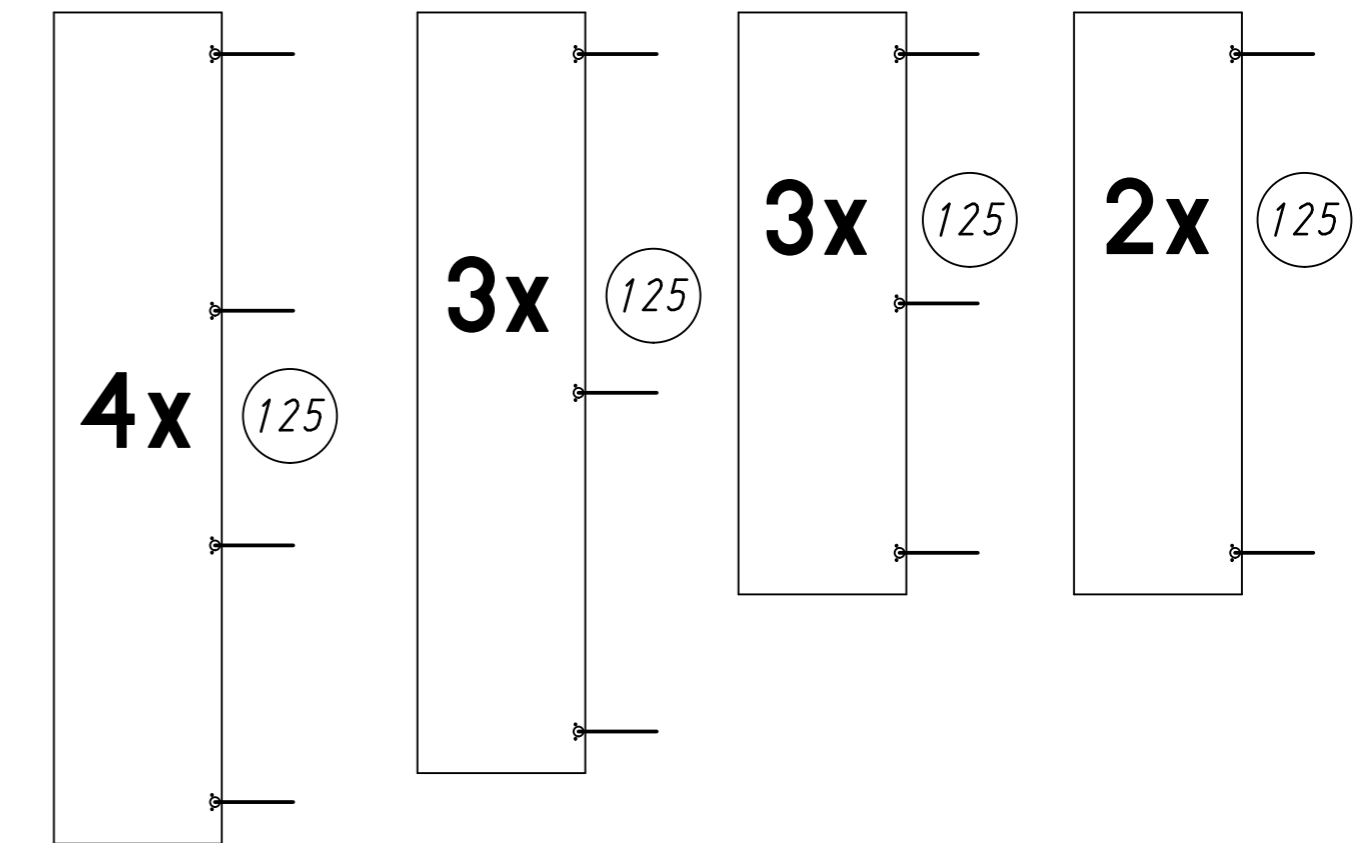
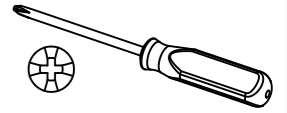
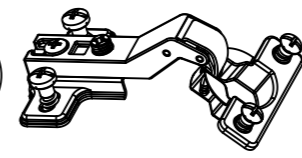

Typ I

Typ II

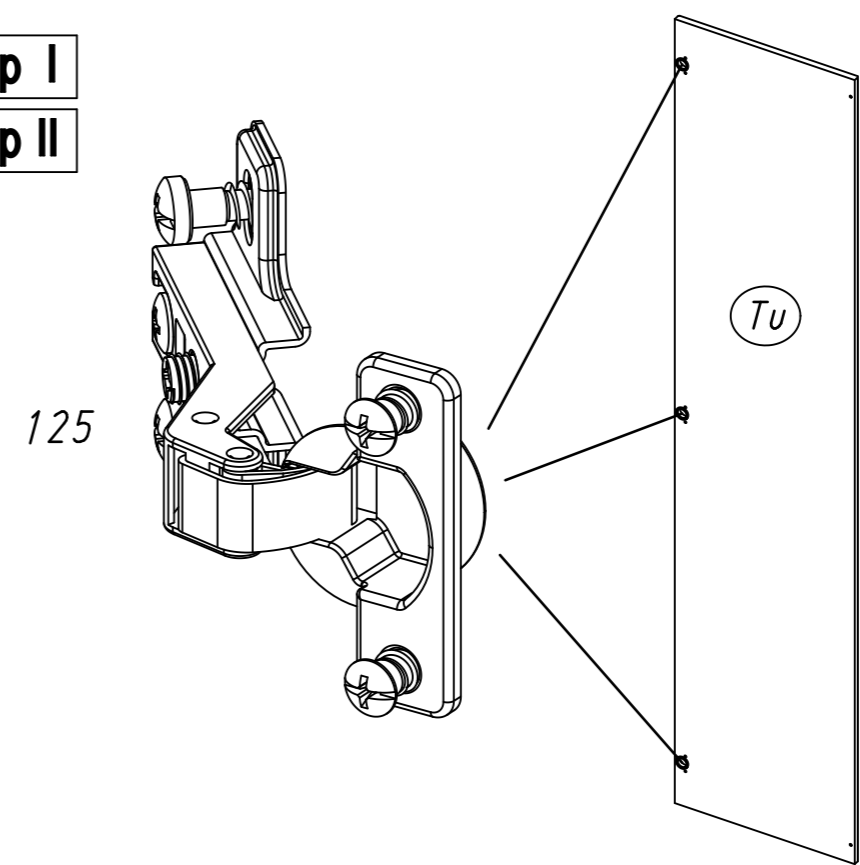

29

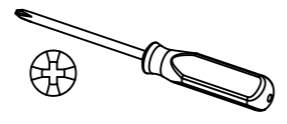

Typ I

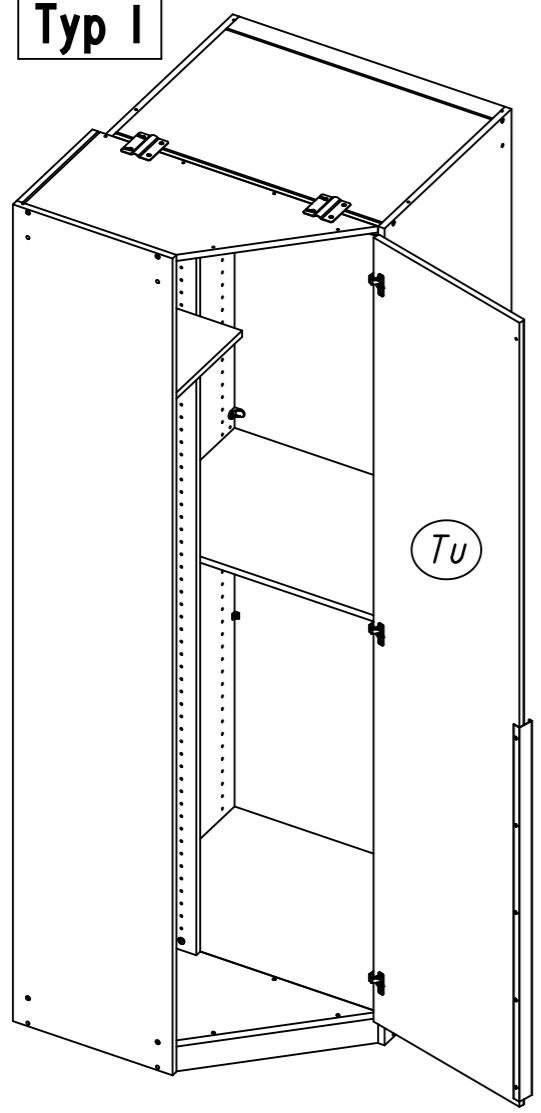

Typ II

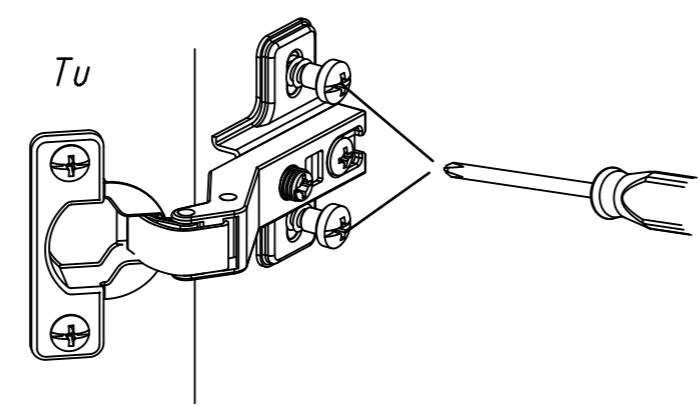
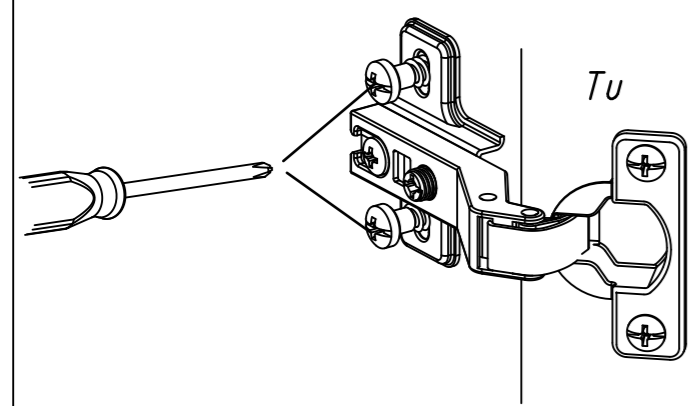
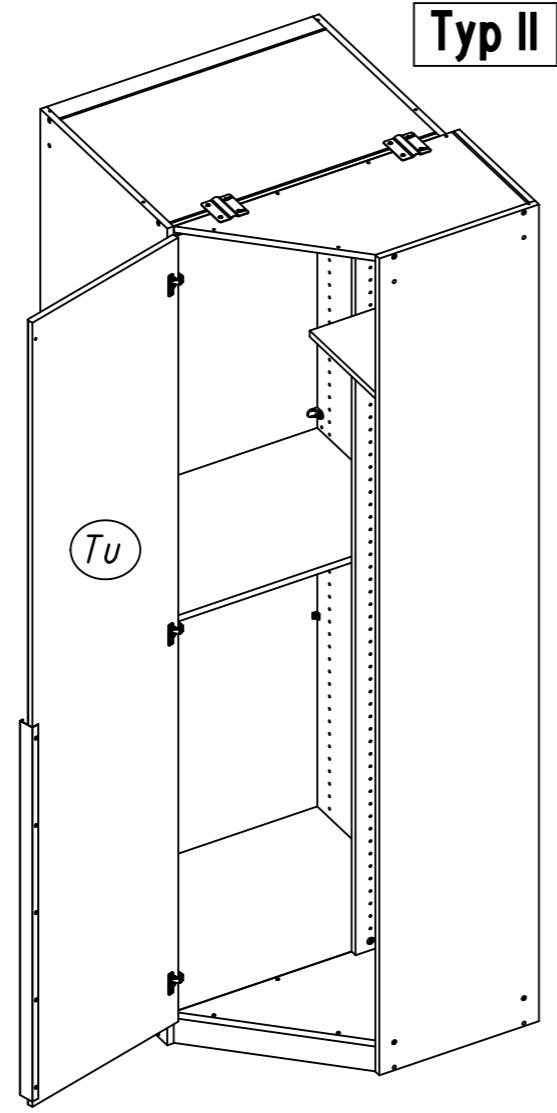

30

